

COUNTY PURCHASING AGENT
Fort Bend County, Texas



Jaime Kovar
County Purchasing Agent

(281) 341-8640
Fax (281) 341-8645

February 22, 2021

TO: All Prospective Bidders

RE: Addendum No. 2 – Fort Bend County Bid 21-056 – Construction for Realignment of Sims Road from 1500 Feet West of TX Spur 10 to Cottonwood School Road for Fort Bend County Bond Project 17119x

Addendum 1:

Attached is addendum 2. Vendors are to use Addendum 2 document while preparing their solicitation response. Changes are to Enclosure #1 – Specifications and Plans.

Immediately upon your receipt of this addendum, please fill out the following information and email this page to Jessica Carabajal at jessica.carabajal@fortbendcountytexas.gov

Company Name

Signature of person receiving addendum

Date

If you have any questions, please contact this office.

Sincerely,

Paige McInnis
County Purchasing Agent Assistant

pw:\tedsi-pw\berntley.com\tedsipw-01\Documents\Projects\2018\2018-2052-01 - Sims Rd Realignment at Spur 106.0 TEDSI Design\6.08 CADD\6.08.02 Reference Files\TEDSIOPENROADS\SIMS ROAD xsection -2020-06-29.dgn

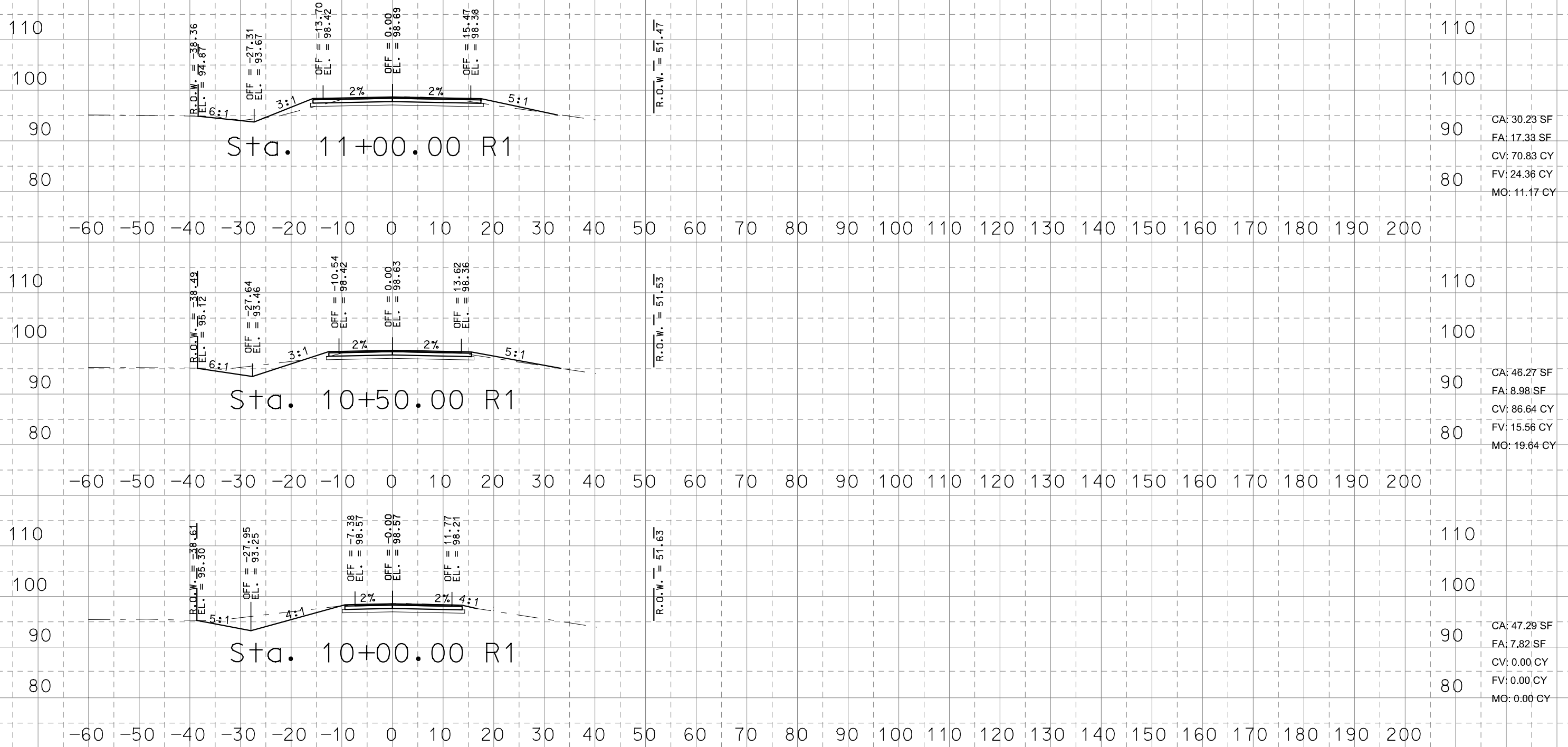

CA: 30.23 SF
FA: 17.33 SF
CV: 70.83 CY
FV: 24.36 CY
MO: 11.17 CY

CA: 46.27 SF
FA: 8.98 SF
CV: 86.64 CY
FV: 15.56 CY
MO: 19.64 CY

CA: 47.29 SF
FA: 7.82 SF
CV: 0.00 CY
FV: 0.00 CY
MO: 0.00 CY

NO.	REVISIONS	DATE	NAME

FORT BEND COUNTY ENGINEERING DEPARTMENT

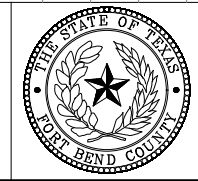

PROJECT TITLE: SIMS ROAD REALIGNMENT	
DRAWN BY:	CROSS SECTION
CK'D BY:	SHEET DESCRIPTION:
SCALE:	CONTRACTOR INFORMATION ONLY
DATE: 8/24/2020	APPROVED BY:
SHEET NO: 1 11	

pw:\tedsi-pw\berntley.com\tedsipw-01\Documents\Projects\2018\2018-2052-01 - Sims Rd Realignment at Spur 106.0 TEDSI Design\6.08 CADD\6.08.02 Reference Files\TEDSIOPENROADS\SIMS ROAD xsection -2020-06-29.dgn

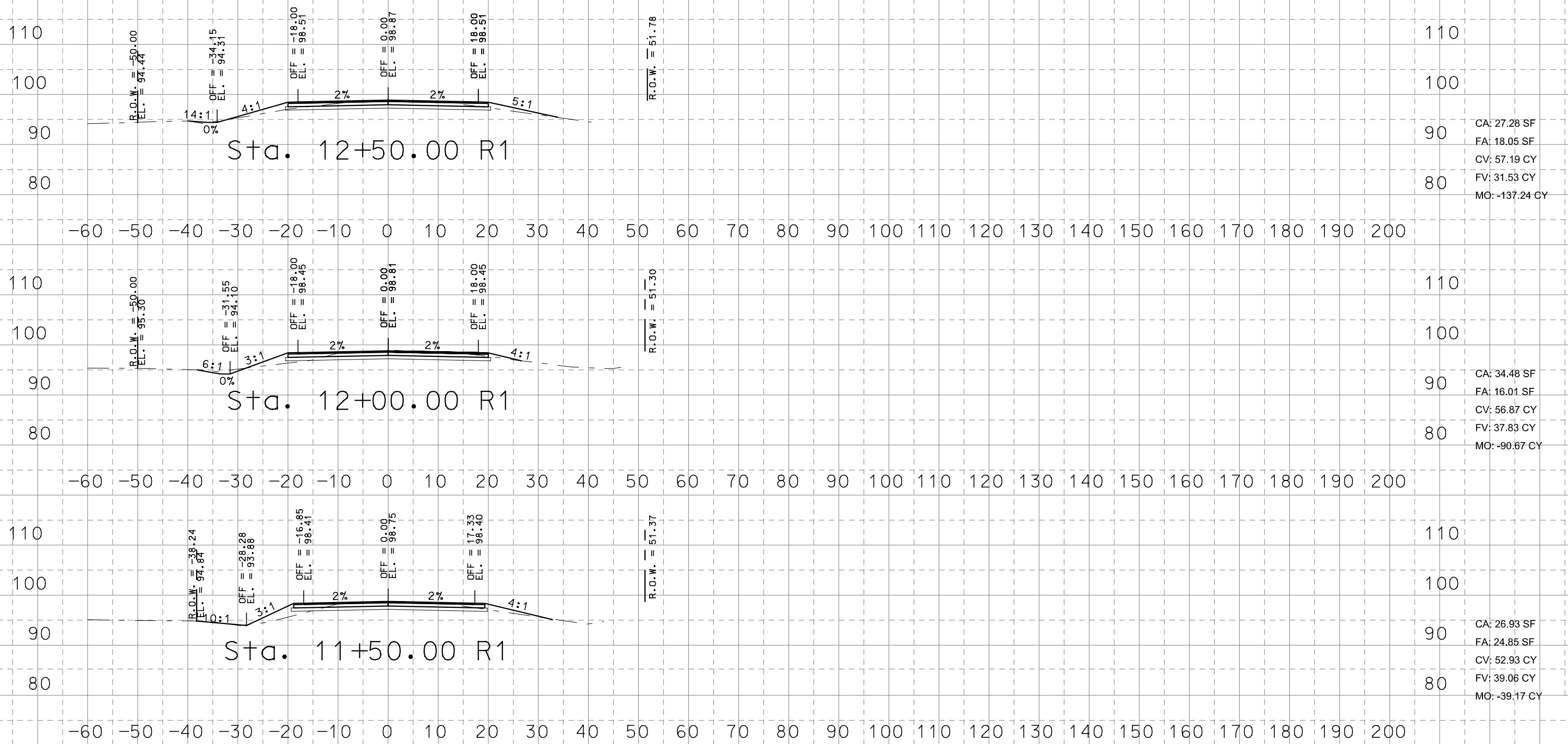

CA: 27.28 SF
FA: 18.05 SF
CV: 57.19 CY
FV: 31.53 CY
MO: -137.24 CY

CA: 34.48 SF
FA: 16.01 SF
CV: 56.87 CY
FV: 37.83 CY
MO: -90.67 CY

CA: 26.93 SF
FA: 24.85 SF
CV: 52.93 CY
FV: 39.06 CY
MO: -39.17 CY

NO.	REVISIONS	DATE	NAME

FORT BEND COUNTY ENGINEERING DEPARTMENT

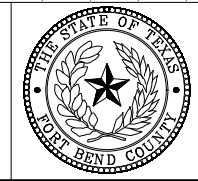

PROJECT TITLE: SIMS ROAD REALIGNMENT	
DRAWN BY:	CROSS SECTION
CK'D BY:	SHEET DESCRIPTION:
SCALE:	CONTRACTOR INFORMATION ONLY
DATE: 8/24/2020	APPROVED BY:
SHEET NO: 2 11	

pw:\tedsi-pw\berntley.com\tedsipw-01\Documents\Projects\2018\2018-2052-01 - Sims Rd Realignment at Spur 106.0 TEDSI Design\6.08 CADD\6.08.02 Reference Files\TEDSIOPENROADS\SIMS ROAD xsection -2020-06-29.dgn

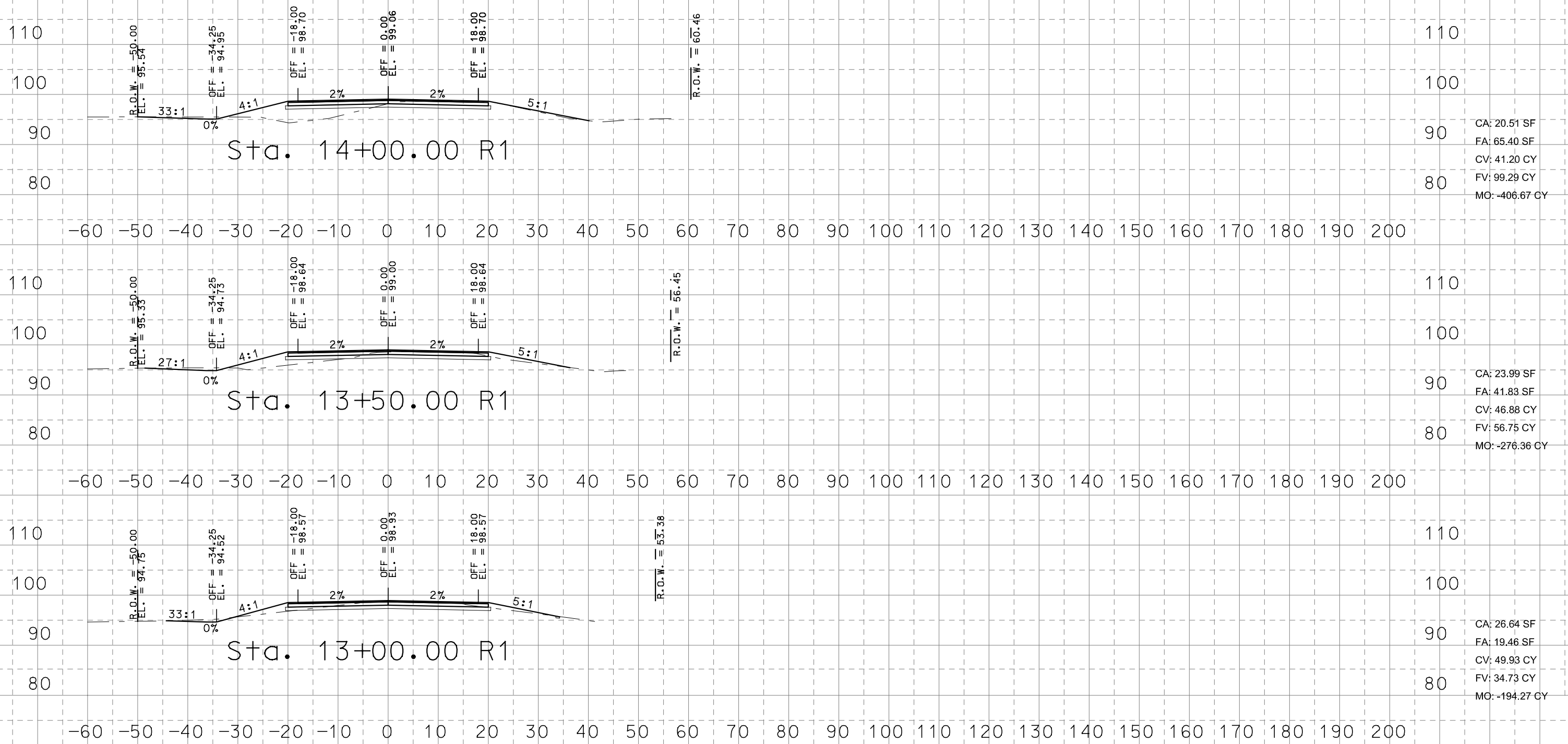

CA: 20.51 SF
FA: 65.40 SF
CV: 41.20 CY
FV: 99.29 CY
MO: -406.67 CY

CA: 23.99 SF
FA: 41.83 SF
CV: 46.88 CY
FV: 56.75 CY
MO: -276.36 CY

CA: 26.64 SF
FA: 19.46 SF
CV: 49.93 CY
FV: 34.73 CY
MO: -194.27 CY

NO.	REVISIONS	DATE	NAME

FORT BEND COUNTY ENGINEERING DEPARTMENT

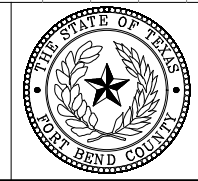

PROJECT TITLE: SIMS ROAD REALIGNMENT	
DRAWN BY:	CROSS SECTION
CK'D BY:	SHEET DESCRIPTION:
SCALE:	CONTRACTOR INFORMATION ONLY
DATE: 8/24/2020	APPROVED BY:
	SHEET NO: 3 11

pw:\tedsi-pw\berntley.com\tedsipw-01\Documents\Projects\2018\2018-2052-01 - Sims Rd Realignment at Spur 106.0 TEDSI Design\6.08 CADD\6.08.02 Reference Files\TEDSIOPENROADS\SIMS ROAD xsection -2020-06-29.dgn

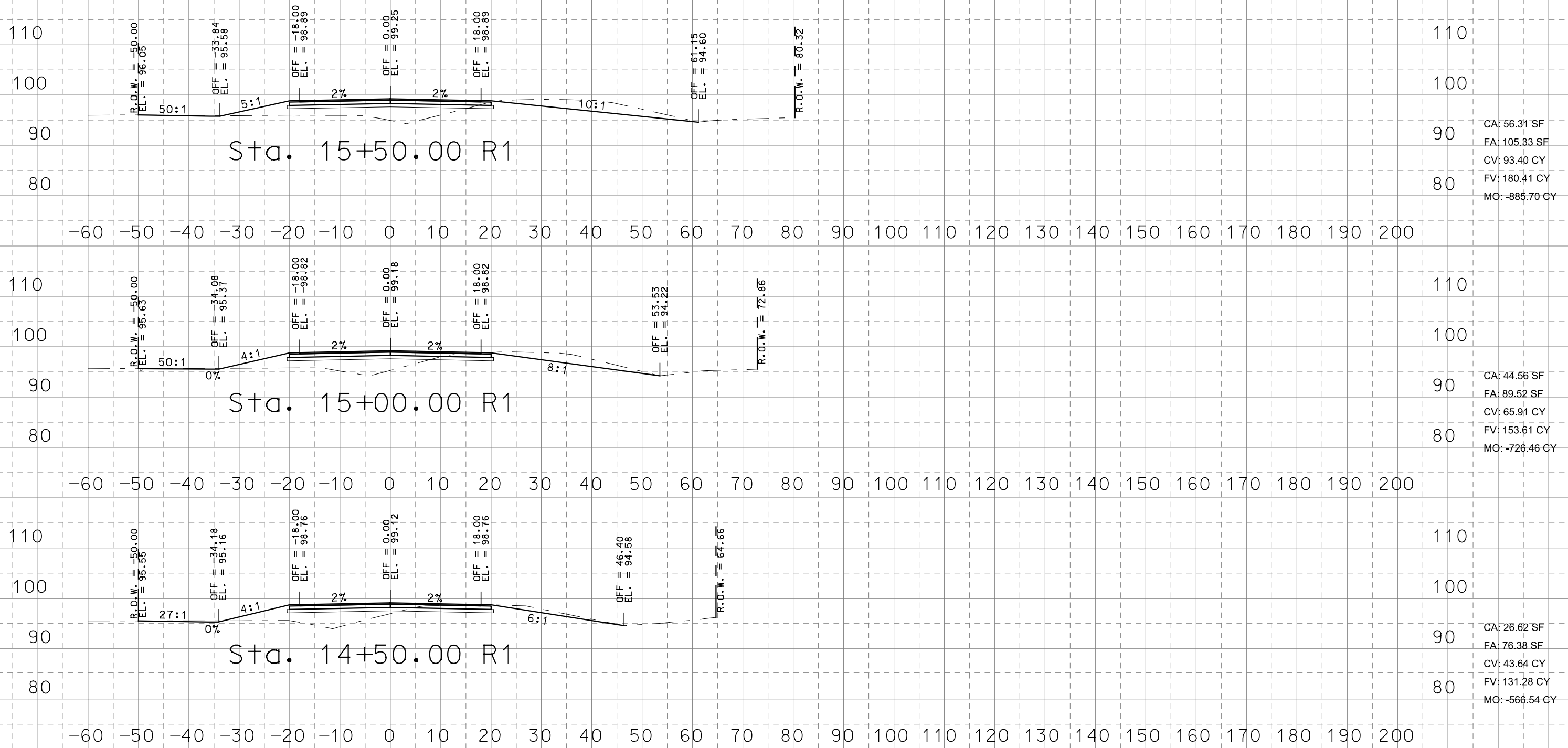

NO.	REVISIONS	DATE	NAME

FORT BEND COUNTY ENGINEERING DEPARTMENT

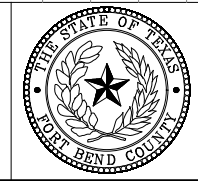

PROJECT TITLE: SIMS ROAD REALIGNMENT	
DRAWN BY:	CROSS SECTION
CK'D BY:	SHEET DESCRIPTION:
SCALE:	CONTRACTOR INFORMATION ONLY
DATE: 8/24/2020	APPROVED BY:
SHEET NO: 4 11	

pw:\tedsi-pw\berntley.com\tedsipw-01\Documents\Projects\2018\2018-2052-01 - Sims Rd Realignment at Spur 106.0 TEDSI Design\6.08 CADD\6.08.02 Reference Files\TEDSIOPENROADS\SIMS ROAD xsection -2020-06-29.dgn

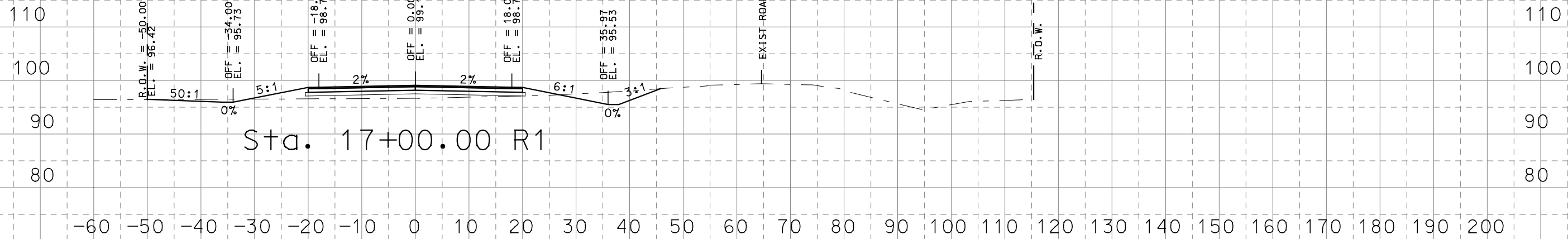

Sta. 17+00.00 R1

CA: 28.19 SF
FA: 63.91 SF
CV: 119.61 CY
FV: 164.70 CY
MO: -1203.12 CY

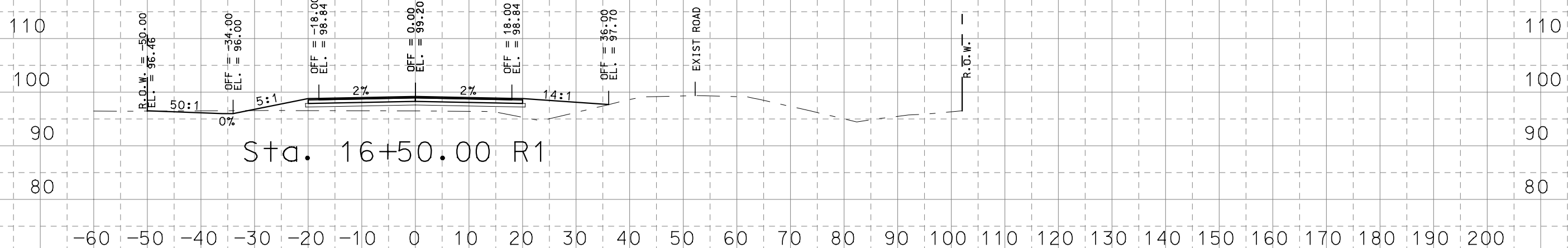

Sta. 16+50.00 R1

CA: 100.99 SF
FA: 113.97 SF
CV: 197.42 CY
FV: 208.57 CY
MO: -1085.80 CY

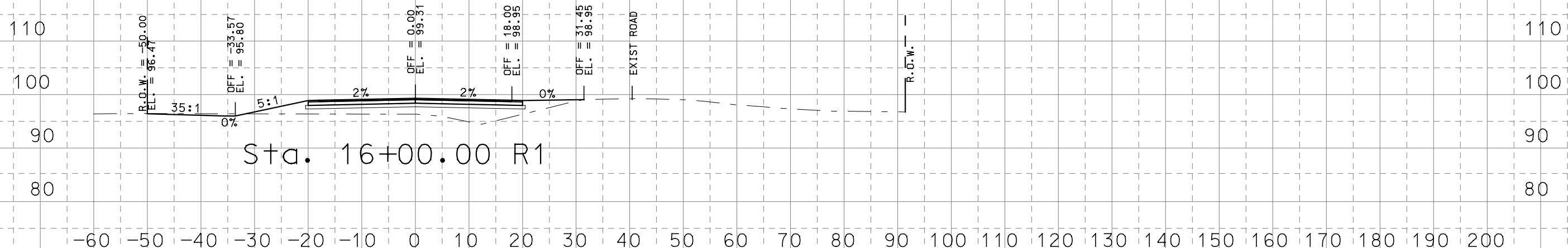

Sta. 16+00.00 R1

CA: 112.23 SF
FA: 111.28 SF
CV: 156.06 CY
FV: 200.57 CY
MO: -1002.43 CY

NO.	REVISIONS	DATE	NAME

FORT BEND COUNTY ENGINEERING DEPARTMENT



PROJECT TITLE: SIMS ROAD REALIGNMENT	
DRAWN BY:	CROSS SECTION
CK'D BY:	SHEET DESCRIPTION:
SCALE:	CONTRACTOR INFORMATION ONLY
DATE: 8/24/2020	APPROVED BY:
	SHEET NO: 5 11

pw:\tedsi-pw\berntley.com\tedsipw-01\Documents\Projects\2018\2018-2052-01 - Sims Rd Realignment at Spur 106.0 TEDSI Design\6.08 CADD\6.08.02 Reference Files\TEDSIOPENROADS\SIMS ROAD xsection -2020-06-29.dgn

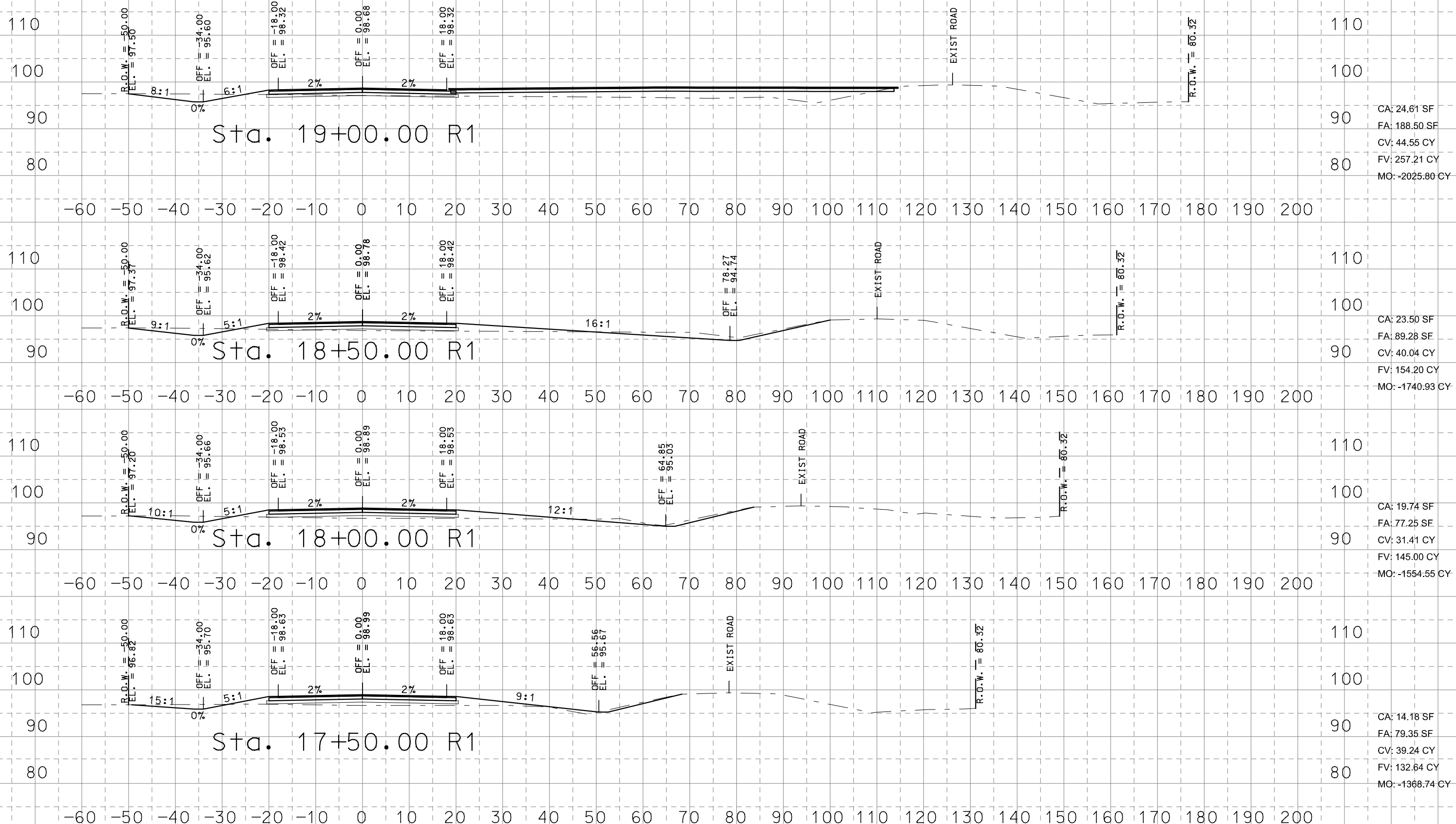

CA: 24.61 SF
 FA: 188.50 SF
 CV: 44.55 CY
 FV: 257.21 CY
 MO: -2025.80 CY

CA: 23.50 SF
 FA: 89.28 SF
 CV: 40.04 CY
 FV: 154.20 CY
 MO: -1740.93 CY

CA: 19.74 SF
 FA: 77.25 SF
 CV: 31.41 CY
 FV: 145.00 CY
 MO: -1554.55 CY

CA: 14.18 SF
 FA: 79.35 SF
 CV: 39.24 CY
 FV: 132.64 CY
 MO: -1368.74 CY

NO.	REVISIONS	DATE	NAME

FORT BEND COUNTY ENGINEERING DEPARTMENT

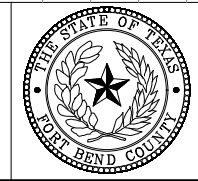

PROJECT TITLE: SIMS ROAD REALIGNMENT	
DRAWN BY:	CROSS SECTION
CK'D BY:	SHEET DESCRIPTION:
SCALE:	CONTRACTOR INFORMATION ONLY
DATE: 8/24/2020	APPROVED BY:
	SHEET NO: 6 11

pw:\tedsi-pw\benfley.com\tedsipw-01\Documents\Projects\2018\2018-2052-01 - Sims Rd Realignment at Spur 106.0 TEDSI Design\6.08 CADD\6.08.02 Reference Files\TEDSIOPENROADS\SIMS ROAD xsection -2020-06-25.dgn

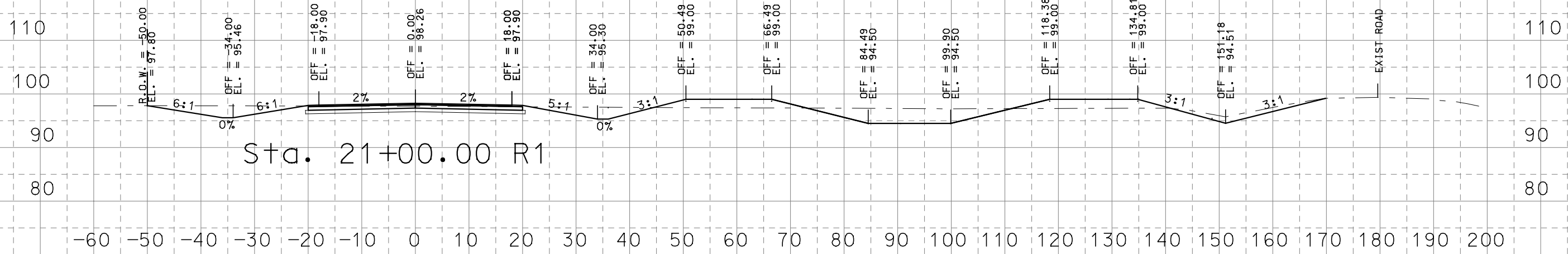

CA: 163.61 SF
 FA: 71.78 SF
 CV: 251.10 CY
 FV: 141.85 CY
 MO: -2419.19 CY

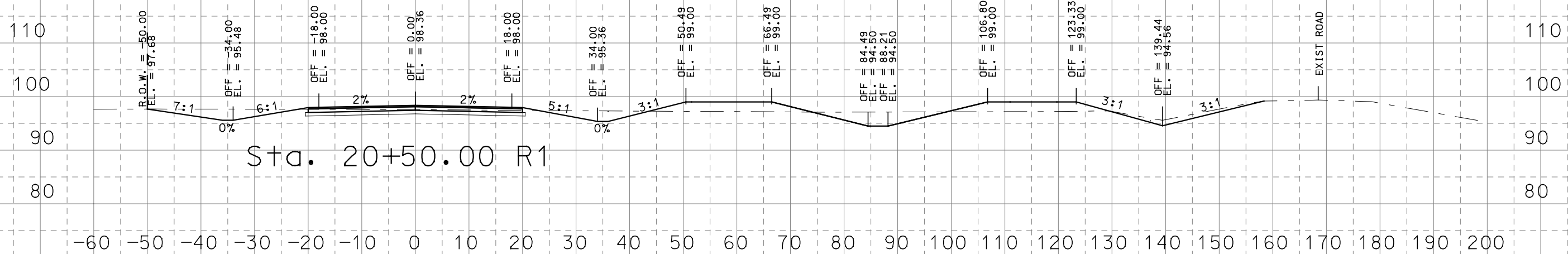

CA: 107.58 SF
 FA: 81.42 SF
 CV: 148.08 CY
 FV: 181.99 CY
 MO: -2446.06 CY

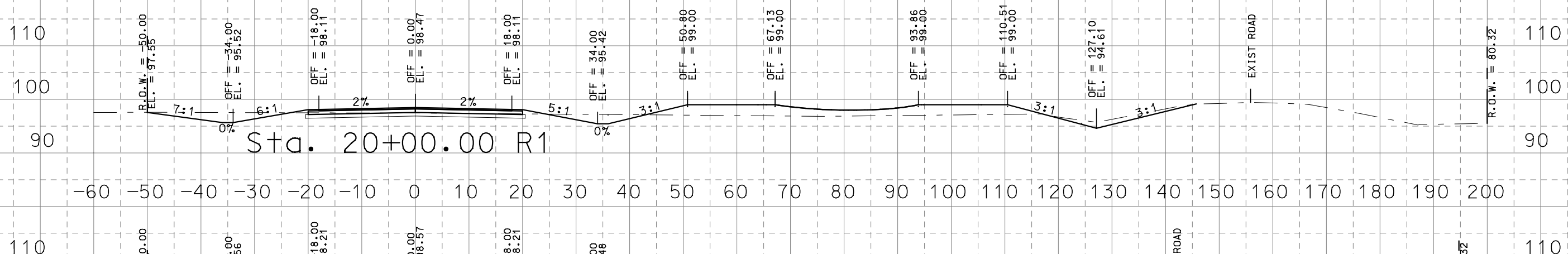

CA: 52.35 SF
 FA: 115.13 SF
 CV: 86.57 CY
 FV: 116.91 CY
 MO: -2329.69 CY

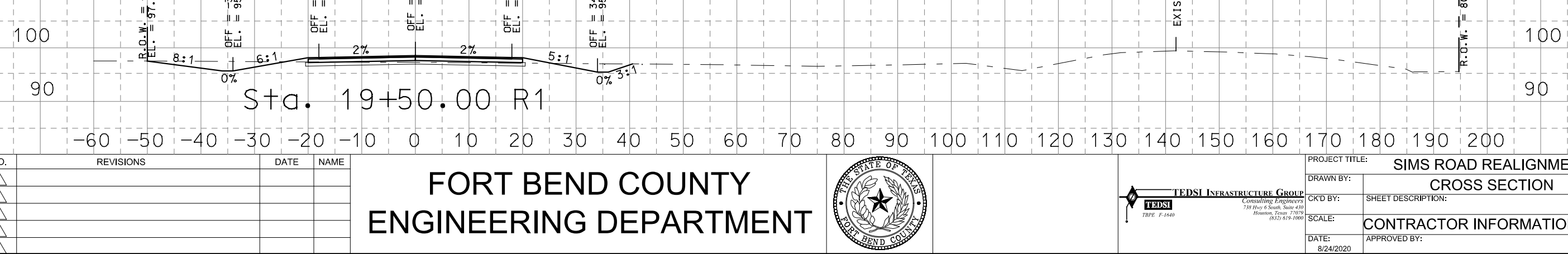

CA: 41.15 SF
 FA: 11.14 SF
 CV: 60.89 CY
 FV: 184.85 CY
 MO: -2221.99 CY

NO.	REVISIONS	DATE	NAME

FORT BEND COUNTY ENGINEERING DEPARTMENT

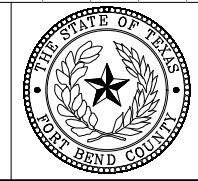

PROJECT TITLE: SIMS ROAD REALIGNMENT	
DRAWN BY:	CROSS SECTION
CK'D BY:	SHEET DESCRIPTION:
SCALE:	CONTRACTOR INFORMATION ONLY
DATE: 8/24/2020	APPROVED BY:
	SHEET NO: 7 / 11

pw:\tedsi-pw\berntley.com\tedsipw-01\Documents\Projects\2018\2018-2052-01 - Sims Rd Realignment at Spur 106.0 TEDSI Design\6.08 CADD\6.08.02 Reference Files\TEDSIOPENROADS\SIMS ROAD xsection -2020-06-29.dgn

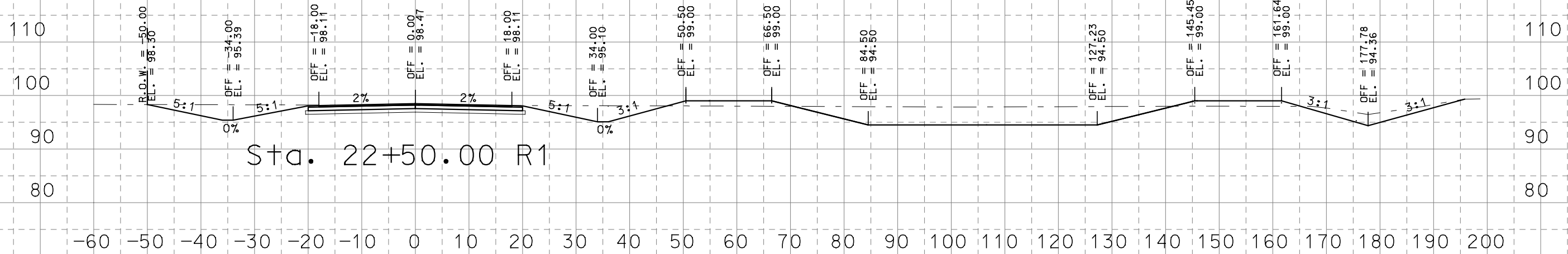

Sta. 22+50.00 R1

CA: 324.63 SF
FA: 33.75 SF
CV: 540.42 CY
FV: 79.25 CY
MO: -1663.80 CY

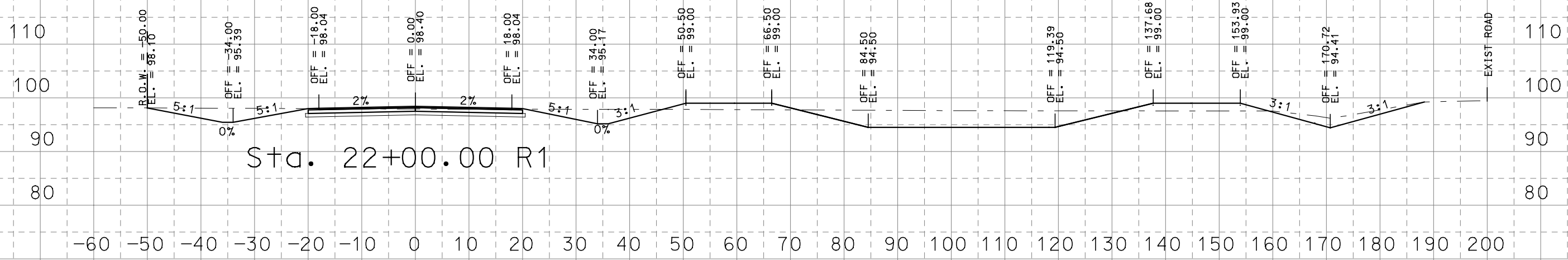

Sta. 22+00.00 R1

CA: 259.02 SF
FA: 51.84 SF
CV: 432.56 CY
FV: 108.62 CY
MO: -2042.74 CY

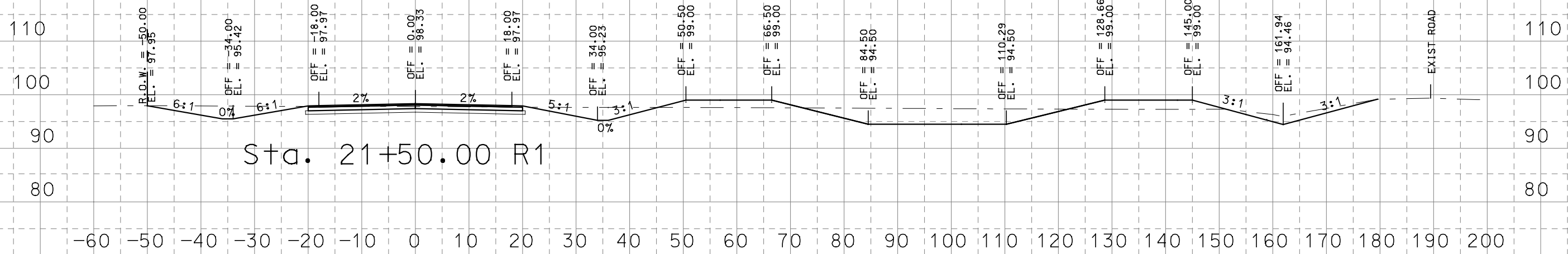

Sta. 21+50.00 R1

CA: 208.14 SF
FA: 65.47 SF
CV: 344.21 CY
FV: 127.08 CY
MO: -2284.39 CY

NO.	REVISIONS	DATE	NAME

FORT BEND COUNTY ENGINEERING DEPARTMENT

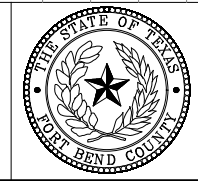

PROJECT TITLE: SIMS ROAD REALIGNMENT	
DRAWN BY:	CROSS SECTION
CK'D BY:	SHEET DESCRIPTION:
SCALE:	CONTRACTOR INFORMATION ONLY
DATE: 8/24/2020	APPROVED BY:
SHEET NO: 8 11	

pw:\tedsi-pw\berntley.com\tedsipw-01\Documents\Projects\2018\2018-2052-01 - Sims Rd Realignment at Spur 106.0 TEDSI Design\6.08 CADD\6.08.02 Reference Files\TEDSIOPENROADS\SIMS ROAD xsection -2020-06-29.dgn

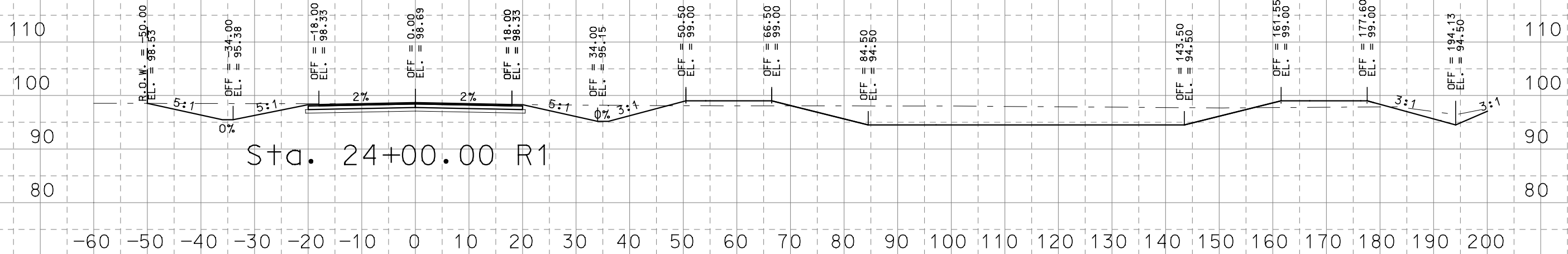

CA: 381.42 SF
 FA: 36.56 SF
 CV: 694.97 CY
 FV: 71.92 CY
 MO: -73.39 CY

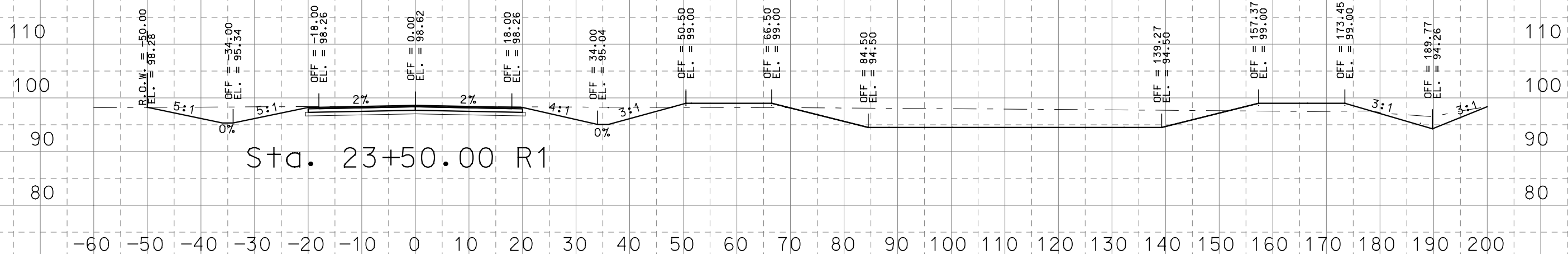

CA: 369.15 SF
 FA: 41.11 SF
 CV: 689.73 CY
 FV: 65.61 CY
 MO: -614.30 CY

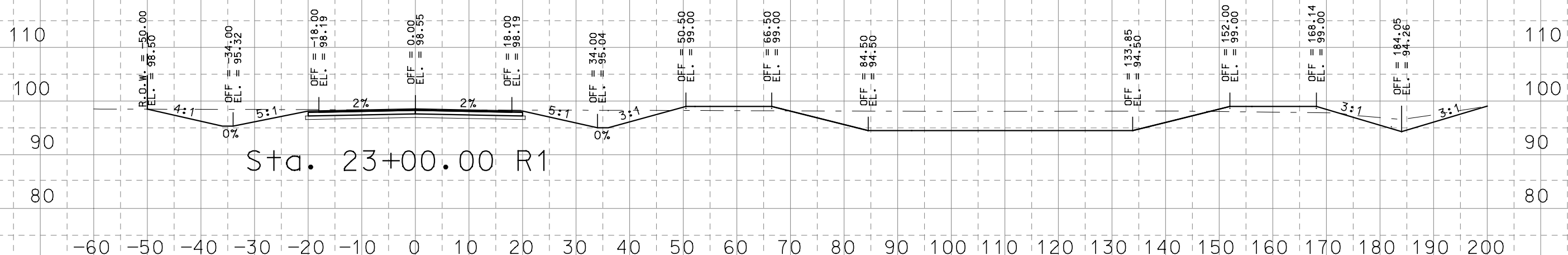

CA: 375.76 SF
 FA: 29.75 SF
 CV: 648.51 CY
 FV: 58.79 CY
 MO: -1156.27 CY

NO.	REVISIONS	DATE	NAME

FORT BEND COUNTY ENGINEERING DEPARTMENT

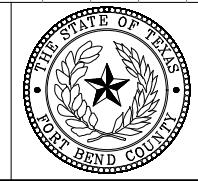

PROJECT TITLE: SIMS ROAD REALIGNMENT	
DRAWN BY:	CROSS SECTION
CK'D BY:	SHEET DESCRIPTION:
SCALE:	CONTRACTOR INFORMATION ONLY
DATE: 8/24/2020	APPROVED BY:
SHEET NO: 9 11	

pw:\tedsi-pw\berntley.com\tedsipw-01\Documents\Projects\2018\2018-2052-01 - Sims Rd Realignment at Spur 106.0 TEDSI Design\6.08 CADD\6.08.02 Reference Files\TEDSIOPENROADS\SIMS ROAD xsection -2020-06-29.dgn

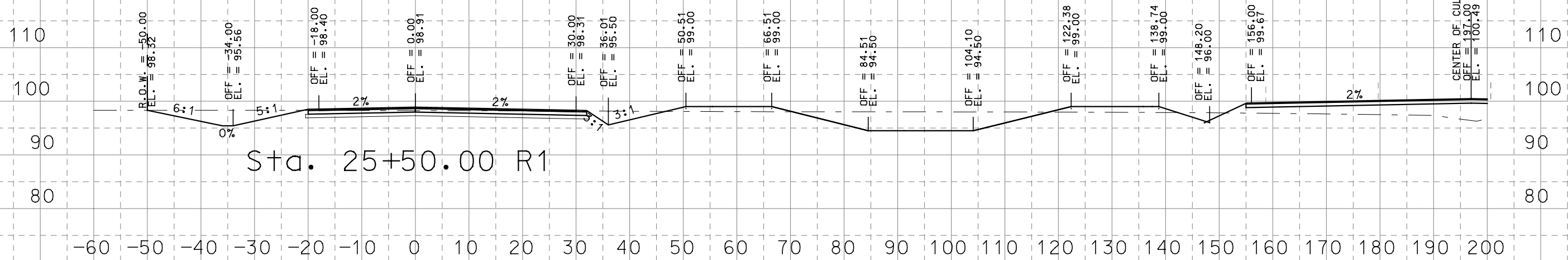

CA: 250.56 SF
 FA: 98.83 SF
 CV: 540.31 CY
 FV: 127.54 CY
 MO: 1256.83 CY

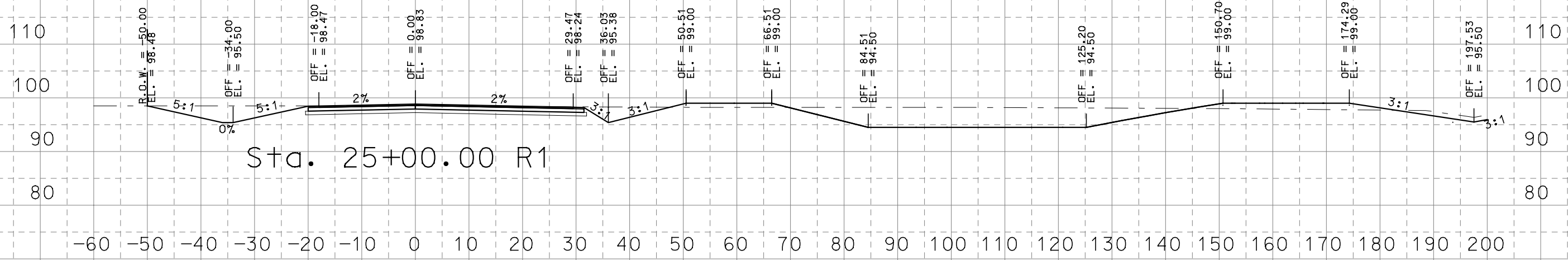

CA: 332.97 SF
 FA: 38.92 SF
 CV: 671.66 CY
 FV: 70.35 CY
 MO: 987.99 CY

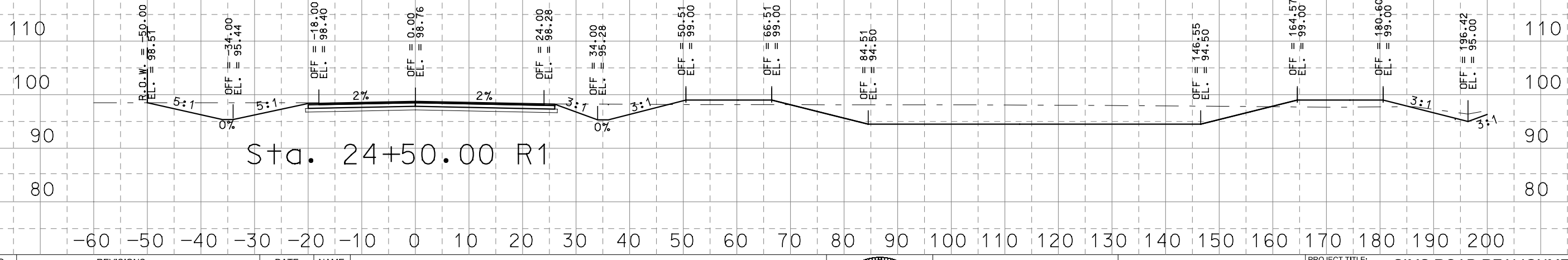

CA: 392.43 SF
 FA: 37.06 SF
 CV: 716.52 CY
 FV: 68.16 CY
 MO: 487.30 CY

NO.	REVISIONS	DATE	NAME

FORT BEND COUNTY ENGINEERING DEPARTMENT

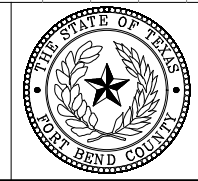

PROJECT TITLE: SIMS ROAD REALIGNMENT	
DRAWN BY:	CROSS SECTION
CK'D BY:	SHEET DESCRIPTION:
SCALE:	CONTRACTOR INFORMATION ONLY
DATE: 8/24/2020	APPROVED BY:
	SHEET NO: 10 11

pw:\tedsi-pw\berntley.com\tedsipw-01\Documents\Projects\2018\2018-2052-01 - Sims Rd Realignment at Spur 106.0 TEDSI Design\6.08 CADD\6.08.02 Reference Files\TEDSIOPENROADS\SIMS ROAD xsection -2020-06-29.dgn

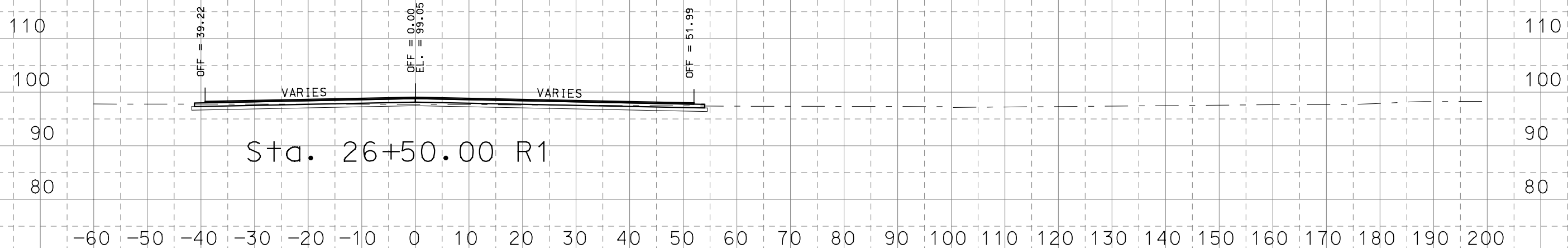

CA: 81.77 SF
 FA: 7.75 SF
 CV: 161.70 CY
 FV: 107.29 CY
 MO: 1089.68 CY

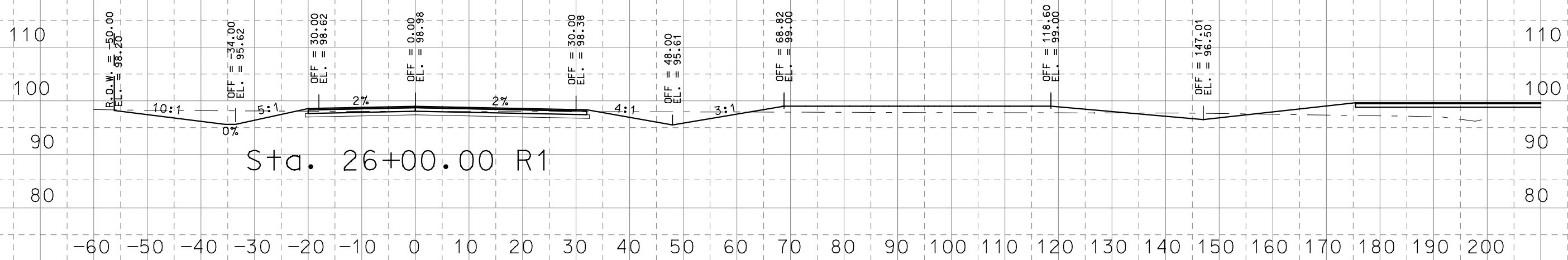

CA: 92.86 SF
 FA: 108.12 SF
 CV: 317.98 CY
 FV: 191.62 CY
 MO: 1207.90 CY

NO.	REVISIONS	DATE	NAME
▲			
▲			
▲			
▲			

FORT BEND COUNTY ENGINEERING DEPARTMENT

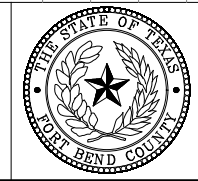

PROJECT TITLE: SIMS ROAD REALIGNMENT	
DRAWN BY:	CROSS SECTION
CK'D BY:	SHEET DESCRIPTION:
SCALE:	CONTRACTOR INFORMATION ONLY
DATE: 8/24/2020	APPROVED BY:
	SHEET NO: 11 11