

Fort Bend County Specification Download Acknowledgment



*Request for Quote
Provide and Install Chain-link Fencing for Freedom Park
RFQ 2014-29*

VENDORS MUST IMMEDIATELY RETURN THIS FORM BY FAX TO 281-341-8645

- Vendor Responsibilities:**
- Vendors are responsible to download and complete any addendums.
 - Vendors will submit responses in accordance with requirements stated on cover of document.

Legal Name of Contracting Company

Contact Person

Complete Mailing Address

Telephone Number

Facsimile Number

Email Address

Signature

Date

*Fort Bend County, Texas
Request For Quote*

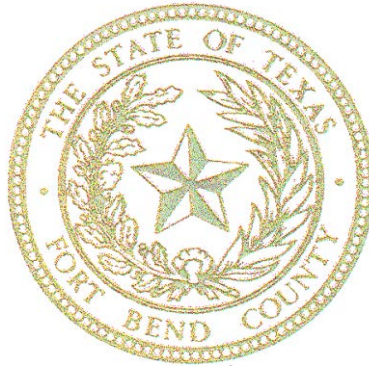

*Provide and Install Chain-link Fencing for Freedom Park
RFQ 2014-29*

SUBMIT QUOTES BY EMAIL TO:

Fort Bend County Purchasing Department
Cheryl Krejci, CPPB
cheryl.krejci@fortbendcountytx.gov

SUBMIT NO LATER THAN:

Friday, January 31, 2014
10:00 AM (Central)

TO INCLUDE WITH RFQ RETURN:

1. Vendor Information page (page 2)
2. Pricing pages 14 & 15
3. Required Forms
4. Required Insurance

**ALL RFQs MUST BE RECEIVED
IN THE COUNTY PURCHASING OFFICE AS STATED HEREIN.
RFQs RECEIVED AS STATED HEREIN
WILL THEN BE OPENED AND EVALUATED.**

Results will not be given by phone.
Results will be provided to vendors in writing
by email and posted to www.fortbendcountytx.gov.

Fort Bend County is always conscious
and extremely appreciative of your effort
in the preparation of this RFQ. Requests for
information must be in writing and directed
to:
Cheryl Krejci, CPPB
Senior Buyer
cheryl.krejci@fortbendcountytx.gov

Vendor Information

Legal Name of Contracting Company

Federal ID Number (Company or Corporation) or Social Security Number (Individual)

Telephone Number

Facsimile Number

Complete Mailing Address (for Correspondence)

City, State and Zip Code

Complete Remittance Address (if different from above)

City, State and Zip Code

Authorized Representative and Title (printed)

Authorized Representative's Email Address

Signature of Authorized Representative

Date

1.0 GENERAL REQUIREMENTS:

- 1.1 Read this entire document carefully. Follow all instructions. You are responsible for fulfilling all requirements and specifications. Be sure you understand them.
- 1.2 General Requirements apply to all advertised RFQs, however, these may be superseded, whole or in part, by the scope, special requirements, specifications, special specifications or other data contained herein.
- 1.3 Governing Law: Vendor is advised that these requirements shall be fully governed by the laws of the State of Texas and that Fort Bend County may request and rely on advice, decisions and opinions of the Attorney General of Texas and the County Attorney concerning any portion of these requirements.
- 1.4 RFQ Returns: Quotes must be returned to the Fort Bend County Purchasing Department as stated herein.
- 1.5 Governing Forms: In the event of any conflict between the terms and provisions of these requirements and the specifications, the specifications shall govern. In the event of any conflict of interpretation of any part of this overall document, Fort Bend County's interpretation shall govern.
- 1.6 Addendums: When specifications are revised, the Fort Bend County Purchasing Department will issue an addendum addressing the nature of the change. Vendors must sign and include it in the returned RFQ package.
- 1.7 Hold Harmless Agreement: Contractor shall indemnify and hold Fort Bend County harmless from all claims for personal injury, death and/or property damage arising from any cause whatsoever, resulting directly or indirectly from contractor's performance. Contractor shall procure and maintain, with respect to the subject matter of this RFQ, appropriate insurance coverage including, as a minimum, public liability and property damage with adequate limits to cover contractor's liability as may arise directly or indirectly from work performed under terms of this RFQ. Certification of such coverage must be provided to the County upon request.
- 1.8 Waiver of Subrogation: Vendor and Vendor's insurance carrier waive any and all rights whatsoever with regard to subrogation against Fort Bend County as an indirect party to any suit arising out of personal or property damages resulting from vendor's performance under this agreement.
- 1.9 Severability: If any section, subsection, paragraph, sentence, clause, phrase or word of these requirements or the specifications shall be held invalid, such holding shall not affect the remaining portions of these requirements and the specifications and it is hereby declared that such remaining portions would have been included in these requirements and the specifications as though the invalid portion had been omitted.

- 1.10 Bonds: If this RFQ requires submission of RFQ guarantee and performance bond, there will be a section herein explaining those requirements. RFQs submitted without the required RFQ bond or cashier's checks are not acceptable.
- 1.11 Taxes: Fort Bend County is exempt from all federal excise, state and local taxes unless otherwise stated in this document. Fort Bend County claims exemption from all sales and/or use taxes under Chapter 20, Title 122a, Vernon's Texas Civil Statutes, as amended. Texas Limited Sales Tax Exemption Certificates will be furnished upon written request to the Fort Bend County Purchasing Department.
- 1.12 Fiscal Funding: A multi-year lease or lease/purchase arrangement (if requested by the specifications), or any contract continuing as a result of an extension option, must include fiscal funding out. If, for any reason, funds are not appropriated to continue the lease or contract, said lease or contract shall become null and void. After expiration of the lease, leased equipment shall be removed by the vendor from the using department without penalty of any kind or form to Fort Bend County. All charges and physical activity related to delivery, installation, removal and redelivery shall be the responsibility of the vendor.
- 1.13 Pricing: Prices for all goods and/or services shall be firm for the duration of this contract and shall be stated on the RFQ sheet. Prices shall be all inclusive. No price changes, additions, or subsequent qualifications will be honored during the course of the contract. All prices must be written in ink or typewritten. Pricing on all transportation, freight, and other charges are to be prepaid by the contractor and included in the RFQ prices. If there are any additional charges of any kind, other than those mentioned above, specified or unspecified, vendor MUST indicate the items required and attendant costs or forfeit the right to payment for such items.
- 1.14 Silence of Specifications: The apparent silence of specifications as to any detail, or the apparent omission from it of a detailed description concerning any point, shall be regarded as meaning that only the best commercial practice is to prevail and that only material and workmanship of the finest quality are to be used. All interpretations of specifications shall be made on the basis of this statement. The items furnished under this contract shall be new, unused of the latest product in production to commercial trade and shall be of the highest quality as to materials used and workmanship. Manufacturer furnishing these items shall be experienced in design and construction of such items and shall be an established supplier of the item RFQ.
- 1.15 Supplemental Materials: Vendors are responsible for including all pertinent product data in the returned RFQ package. Literature, brochures, data sheets, specification information, completed forms requested as part of the RFQ package and any other facts which may affect the evaluation and subsequent contract award should be included. Materials such as legal documents and contractual agreements, which the vendor wishes to include as a condition of the RFQ, must also be in the returned RFQ package. Failure to include all necessary and proper supplemental materials may be cause to reject the entire RFQ.

- 1.16 Material Safety Data Sheets: Under the "Hazardous Communication Act", commonly known as the "Texas Right To Know Act", a vendor must provide to County and using departments, with each delivery, material safety data sheets, which are, applicable to hazardous substances defined in the Act. Vendors are obligated to maintain a current, updated file in the Fort Bend County Purchasing Department. Failure of the vendor to maintain such a file will be cause to reject any RFQ applying thereto.
- 1.17 Name Brands: Specifications may reference name brands and model numbers. It is not the intent of Fort Bend County to restrict these RFQs in such cases, but to establish a desired quality level of merchandise or to meet a pre-established standard due to like existing items. Vendors may offer items of equal stature and the burden of proof of such stature rests with them. Fort Bend County shall act as sole judge in determining equality and acceptability of products offered.
- 1.18 Color Selection: Determination of colors of materials is a right reserved by the using department unless otherwise specified in the RFQ. Unspecified colors shall be quoted as standard colors, not colors, which require up charges or special handling. Unspecified fabrics or vinyl should be construed as medium grade. If vendor fails to get color/material approvals prior to delivery of merchandise, the using department may refuse to accept the items and demand correct shipment without penalty, subject to other legal remedies.
- 1.19 Evaluation: Evaluation shall be used as a determinant as to which RFQ items or services are the most efficient and/or most economical for the County. It shall be based on all factors, which have a bearing on price and performance of the items in the user environment. All RFQs are subject to tabulation by the Fort Bend County Purchasing Department and recommendation to Fort Bend County Commissioners Court. Compliance with all RFQ requirements, delivery and needs of the using department are considerations in evaluating RFQs. Pricing is NOT the only criteria for making an award. The Fort Bend County Purchasing Department reserves the right to contact any vendor, at any time, to clarify, verify or request information with regard to any RFQ.
- 1.20 Inspections: Fort Bend County reserves the right to inspect any item(s) or service location for compliance with specifications and requirements and needs of the using department. If a vendor cannot furnish a sample of a RFQ item, where applicable, for review, or fails to satisfactorily show an ability to perform, the County can reject the RFQ as inadequate.
- 1.21 Testing: Fort Bend County reserves the right to test equipment, supplies, material and goods RFQ for quality, compliance with specifications and ability to meet the needs of the user. Demonstration units must be available for review. Should the goods or services fail to meet requirements and/or be unavailable for evaluation, the RFQ is subject to rejection.

- 1.22 **Disqualification of vendor:** Upon signing this RFQ document, a vendor offering to sell supplies, materials, services, or equipment to Fort Bend County certifies that the vendor has not violated the antitrust laws of this state codified in section 15.01, et seq., Business & Commerce Code, or the federal antitrust laws, and has not communicated directly or indirectly the RFQ made to any competitor or any other person engaged in such line of business. Any or all RFQs may be rejected if the County believes that collusion exists among the vendors. RFQs in which the prices are obviously unbalanced may be rejected. If multiple RFQs are submitted by a vendor and after the RFQs are opened, one of the RFQs is withdrawn, the result will be that all of the RFQs submitted by that vendor will be withdrawn; however, nothing herein prohibits a vendor from submitting multiple RFQs for different products or services.
- 1.23 **Awards:** Fort Bend County reserves the right to award this contract on the basis of lowest and best RFQ in accordance with the laws of the State of Texas, to waive any formality or irregularity, to make awards to more than one vendor, to reject any or all RFQs. In the event the lowest dollar vendor meeting specifications is not awarded a contract, the vendor may present evidence concerning his responsibility to the Purchasing Department.
- 1.24 **Assignment:** The successful vendor may not assign, sell or otherwise transfer this contract without written permission of Fort Bend County Commissioners Court.
- 1.25 **Contract Obligation:** Fort Bend County must award the contract before it becomes binding on Fort Bend County or the vendors. Department heads are not authorized to sign agreements for Fort Bend County. Binding agreements shall remain in effect until all products and/or services covered by this purchase have been satisfactorily delivered and accepted.

2.0 TERMS AND CONDITIONS:

- 2.1 **Seller to Package Goods:** Seller will package goods in accordance with good commercial practice. Each delivery container shall be clearly and permanently marked as follows (a) Seller's name and address; (b) Consignee's name, address and purchase order number and the RFQ number if applicable; (c) Container number and total number of containers (e.g. box 1 of 4 boxes); and (d) the number of the container bearing the packing slip. Seller shall bear cost of packaging unless otherwise provided. Goods shall be suitably packed to secure lowest transportation costs and to conform to requirements of common carriers and any applicable specifications. Fort Bend County's count or weight shall be final and conclusive on shipments not accompanied by packing list.
- 2.2 **Shipment Under Reservation Prohibited:** Seller is not authorized to ship goods under reservation and no tender of a bill of lading will operate as a tender of goods.

- 2.3 Title and Risk of Loss: The title and risk of loss of the goods shall not pass to the County until a County employee actually receives and takes possession of the goods at the point or points of delivery.
- 2.4 Delivery Terms: F.O.B. Destination Freight Prepaid, Inside Delivery, unless delivery terms are specified otherwise on Purchase Order.
- 2.5 No Replacement of Defective Tender: Every tender or delivery of goods must fully comply with all provisions of the Purchase Order as to time of delivery, quality and the like. If a tender is made which does not fully conform, this shall constitute a breach and Seller shall not have the right to substitute a conforming tender.
- 2.6 Place of Delivery: The place of delivery shall be that set forth in the block of the purchase order entitled "Ship To". Any change thereto shall be effective by modification as provided for in Clause number 2.20 "Modifications", hereof. The terms of this agreement are "no arrival, no sale", at the discretion of Fort Bend County.
- 2.7 Invoices and Payments:
 - 2.7.1 Seller shall submit separate invoices, in duplicate. Invoices shall indicate the purchase order number and the RFQ number if applicable. Invoices shall be itemized and transportation charges, if any, shall be listed separately. A copy of the bill of lading, and the freight waybill when applicable should be attached to the invoice.
 - 2.7.2 Fort Bend County's obligation is payable only and solely from funds available for the purpose of this purchase. Lack of funds shall render the order null and void to the extent funds are not available and any delivered but unpaid goods will be returned to Seller by the county.
 - 2.7.3 Do not include Federal Excise, State, or City Sales Tax. Fort Bend County is a tax exempt governmental entity.
- 2.8 Gratuities: Fort Bend County may, by written notice to the Seller, cancel any order without liability, if it is determined by the County that gratuities, in the form of entertainment, gifts, or otherwise were offered or given by the Seller, or any agent or representative of the Seller to any officer or employee of Fort Bend County with a view toward securing an order. In the event an order is canceled by the County pursuant to this provision, the County shall be entitled, in addition to any other rights and remedies, to recover or withhold the amount of the cost incurred by Seller in providing such gratuities.

- 2.9 Special Tools and Test Equipment: If the price stated on the face of an order includes the cost of any special tooling or special test equipment fabricated or required by Seller for the purpose of filing this order, such special tooling equipment and any process sheets related thereto shall become the property of the County and to the extent feasible shall be identified by the Seller as such.
- 2.10 Warranty/Price:
- 2.10.1 The price to be paid by the County shall be that contained in Seller's quote or RFQ which Seller warrants to be no higher than Seller's current prices on orders by others for products of the kind and specification covered by an order for similar quantities under similar or like conditions and methods of purchase. In the event Seller breaches this warranty the prices of the items shall be reduced to the Seller's current prices on orders by others. Fort Bend County may cancel this contract without liability.
- 2.10.2 The Seller warrants that no person or selling agency has been employed or retained to solicit or secure any County order based upon any agreement or understanding for commission, percentage, brokerage, or contingent fee excepting bona fide employees of bona fide established commercial or selling agencies maintained by the Seller for the purpose of securing business. A breach or violation of this warranty gives the County the right, in addition to any other right or rights, to cancel this contract without liability.
- 2.11 Warranty Product: Seller shall not limit or exclude any implied warranties and any attempt to do so shall render an order voidable at the option of the County. Seller warrants that the goods furnished will conform to the specifications, drawings, and description listed in the RFQ invitation and purchase order as applicable, and to the sample(s) furnished by Seller if any. In the event of a conflict between the specifications, drawings, and descriptions, the specifications shall govern.
- 2.12 Safety Warranty: Seller warrants that the product sold to Fort Bend County shall conform to the standards promulgated by the U.S. Department of Labor under the Occupational Safety and Health Act of 1970. In the event the product does not conform to OSHA standards, the County may return the product for correction or replacement at the Seller's expense. In the event Seller fails to make the appropriate correction within 10 days, correction made by the County will be at Seller's expense.
- 2.13 No Warranty by Fort Bend County Against Infringements: As part of a contract for sale Seller agrees to ascertain whether goods manufactured in accordance with the specifications will give rise to the rightful claim of any third person by way of infringement. Fort Bend County makes no warranty that the production of goods according to the specification will not give rise to such a claim and in no event shall Fort Bend County be liable to Seller for indemnification in the event the Seller is sued on the grounds of infringement or the like. If Seller is of the

opinion that an infringement will result, he will notify Fort Bend County to this effect in writing within two days after the receiving Purchase Order. If the County does not receive notice and is subsequently held liable for the infringement, Seller will defend and save the County harmless. If Seller in good faith ascertains that production of the goods in accordance with the specifications will result in infringement, this contract shall be null and void except that the County will pay Seller the reasonable cost of his search as to infringements.

- 2.14 **Right of Inspection:** The County shall have the right to inspect the goods at delivery before accepting them.
- 2.15 **Cancellation:** Fort Bend County shall have the right to cancel for default all or any part of the undelivered portion of an order if Seller breaches any of the terms hereof including warranties of Seller, or if the Seller becomes insolvent or files for protection under the bankruptcy laws. Such rights of cancellation are in addition to and not in lieu of any other remedies, which Fort Bend County may have in law or equity.
- 2.16 **Termination:** The performance of work under a Purchase Order may be terminated in whole or in part by the County in accordance with this provision. Termination of work there under shall be effected by the delivery to the Seller of a "Notice of Termination" specifying the extent to which performance of work under the order is terminated and the date upon which such termination becomes effective. Such right of termination is in addition to and not in lieu of rights of Fort Bend County set forth in Clause 15 herein.
- 2.17 **Force Majeure:** Force Majeure means a delay encountered by a party in the performance of its obligations under this Agreement, which is caused by an event beyond the reasonable control of that party. Without limiting the generality of the foregoing, "Force Majeure" shall include but not be restricted to the following types of events: acts of God or public enemy; acts of governmental or regulatory authorities; fires, floods, epidemics or serious accidents; unusually severe weather conditions; strikes, lockouts, or other labor disputes; and defaults by subcontractors. In the event of a Force Majeure, the affected party shall not be deemed to have violated its obligations under this Agreement, and the time for performance of any obligations of that party shall be extended by a period of time necessary to overcome the effects of the Force Majeure, provided that the foregoing shall not prevent this Agreement from terminating in accordance with the termination provisions. If any event constituting a Force Majeure occurs, the affected party shall notify the other parties in writing, within twenty-four (24) hours, and disclose the estimated length of delay, and cause of the delay.
- 2.18 **Assignment-Delegation:** No right or interest in an order shall be assigned or delegation of any obligation made by Seller without the written permission of Fort Bend County. Any attempted assignment or delegation by Seller shall be wholly void and totally ineffective for all purposes unless made in conformity with this paragraph.

- 2.19 Waiver: No claim or right arising out of a breach of any contract can be discharged in whole or in part by a waiver or renunciation of the claim or right unless the waived or renunciation is supported by consideration and is in writing signed by the aggrieved party.
- 2.20 Modification: A Purchase Order can be modified or rescinded only by a writing signed by both of the parties or their duly authorized agents.
- 2.21 Parol Evidence: This writing is intended by the parties as a final expression of their agreement and is intended also as a complete and exclusive statement of the terms of this agreement. No course of prior dealings between the parties and no usage of the trade shall be relevant to supplement or explain any terms rendered under this agreement and shall not be relevant to determine the meaning of this agreement even though the accepting or acquiescing party has knowledge of the performance and opportunity for objection. Whenever a term defined by the Uniform Commercial Code is used in this agreement, the definition contained in the Code is to control.
- 2.22 Applicable Law: This agreement shall be governed by the Uniform Commercial Code. Whenever the term "Uniform Commercial Code" is used it shall be construed as meaning the Uniform Commercial Code as adopted in the State of Texas and in effect on the date of the purchase order.
- 2.23 Advertising: Seller shall not advertise or publish without the County's prior consent the fact that Fort Bend County has entered into any contract, except to the extent necessary to comply with proper requests for information from an authorized representative of the federal, state, or local government.
- 2.24 Right to Assurance: Whenever the County in good faith has reason to question the other party's intent to perform. The County may demand that the other party give written assurance of his intent to perform. In the event that a demand is made and no assurance is given within five (5) days, the County may treat this failure as an anticipatory repudiation of the contract.
- 2.25 Venue: Both parties agree that venue for any litigation arising from this contract shall lie in Richmond, Fort Bend County, Texas.
- 2.26 Prohibition Against Personal Interest in Contracts: No officer or employee of the County shall have a financial interest, direct or indirect, in any contract with the County, or shall be financially interested, directly or indirectly, in the sale to the County of any land, materials, supplies, or service, except on behalf of the County as an officer or employee. Any willful violation of this section shall constitute malfeasance in office, and any officer or employee guilty thereof shall be subject to disciplinary action under applicable laws, statutes and codes of the State of Texas. Any violation of this section, with the knowledge, expressed or implied of the person or corporation contracting with the County shall render the contract involved voidable by the County Commissioners Court.

3.0 SCOPE:

It is the intent of Fort Bend County to contract with one (1) vendor to provide all materials, supplies, equipment, tools, services, labor and supervision necessary to provide and install chain-link fencing and accessories for Fort Bend County Freedom Park, 18955 Westheimer Parkway, Houston, TX 77094.

4.0 AWARD:

This contract will be awarded to the overall lowest and best quote.

5.0 PRE-RFQ MEETING:

A Pre-RFQ meeting will be held at the Fort Bend County Freedom Park, located at 18955 Westheimer Parkway, Houston, TX 77094, **Friday, January 24, 2014 at 1:30pm**. Interested vendors are encouraged to attend as this is the only date and time available to conduct a site visit. Vendors are responsible for obtaining their own field measurements.

6.0 INSURANCE:

- 6.1 All vendors must submit, with RFQ, a certificate of insurance indicating coverage in the amounts stated below. In lieu of submitting a certificate of insurance, vendors may submit, with RFQ, a notarized statement from an Insurance company, authorized to conduct business in the State of Texas, and acceptable to Fort Bend County, guaranteeing the issuance of an insurance policy, with the coverage stated below, to the contractor named therein, if successful, upon award of this Contract. Failure to provide insurance certificate or notarized statement will result in disqualification of request for quote.
- 6.2 The certificates of insurance to be satisfactory to Fort Bend County, naming the Contractor and its employees as insured:
 - 6.2.1 Workers Compensation in accordance with the laws of the State of Texas. Substitutes to genuine Workers' Compensation Insurance will not be allowed.
 - 6.2.2 Employers' Liability insurance with limits of not less than \$1,000,000 per injury by accident, \$1,000,000 per injury by disease, and \$1,000,000 per bodily injury by disease.
 - 6.2.3 Commercial general liability insurance with a limit of not less than \$1,000,000 each occurrence and \$2,000,000 in the annual aggregate. Policy shall cover liability for bodily injury, personal injury, and property damage and products/completed operations arising out of the business operations of the policyholder.

- 6.2.4 Business Automobile Liability coverage applying to owned, non-owned and hired automobiles with limits not less than \$1,000,000 each occurrence combined single limit for Bodily Injury and Property Damage combined.
- 6.3 County and the members of Commissioners Court shall be named as additional insured to all required coverage except for Workers' Compensation and Professional Liability (if required). All Liability policies written on behalf of Contractor shall contain a waiver of subrogation in favor of County and members of Commissioners Court.
- 6.4 If required coverage is written on a claims-made basis, Contractor warrants that any retroactive date applicable to coverage under the policy precedes the effective date of the Contract and that continuous coverage will be maintained or an extended discovery period will be exercised for a period of 2 years beginning from the time the work under this Contract is completed.
- 6.5 Contractor shall not commence any portion of the work under this Contract until it has obtained the insurance required herein and certificates of such insurance have been filed with and approved by Fort Bend County.
- 6.6 No cancellation of or material change to the policies may be made without sixty (60) days prior, written notification to Fort Bend County.
- 6.7 Approval of the insurance by Fort Bend County shall not relieve or decrease the liability of the Contractor.
- 6.8 All insurance companies must maintain A.M.Best's rating of A-VII or higher.

7.0 INDEMNIFICATION:

Contractor agrees to indemnify, defend and hold the County harmless from each and every claim, demand, suit, action, proceeding, lien or judgment caused by or arising out of, directly or indirectly, or in connection with the acts and omissions of Contractor pursuant to this Agreement.

- 7.1 Contractor shall timely report all such matters to the County and shall, upon the receipt of any such claim, demand, suit, action, proceeding, lien or judgment, not later than the fifteenth day of each month; provide the County with a written report on each such matter covered by this paragraph and by paragraph 2. below, setting forth the status of each matter, the schedule or planned proceedings with respect to each matter and the cooperation or assistance, if any, of the County required by Contractor in the defense of each matter.
- 7.2 The County shall timely forward to Contractor copies of any and all claims, demands, suits, actions, proceedings or judgments which it may receive and which it may contend is covered by this section. Thereafter, the County shall fully cooperate with Contractor in its defense of each such matter.

- 7.3 Contractor's duty to defend indemnifies and hold the County harmless shall be absolute. It shall not abate or end by reason of the expiration or termination of this Agreement unless otherwise agreed by the County in writing. The provisions of this section shall survive the termination of the Agreement and shall remain in full force and effect with respect to all such matters no matter when they arise.
- 7.4 In the event of any dispute between the parties as to whether a claim, demand, suit, action, proceeding, lien or judgment appears to have been caused by or appears to have arisen out of or in connection with acts or omissions of Contractor, Contractor shall never-the-less fully defend such claim, demand, suit, action, proceeding, lien or judgment until and unless there is a determination by a court of competent jurisdiction that the acts and omissions of Contractor are not at issue in the matter. In such event, the County shall promptly reimburse Contractor for its costs of defense.
- 7.5 In the event that any such matter being so defended by Contractor also involves any claim of negligence or wrongful action by the County, the County shall have the obligation to participate in the defense of the matter through separate counsel.
- 7.6 Contractor shall have full authority to resolve all matters being defended by it providing such settlement(s) shall not involve any findings adverse to the County or and shall not involve or require any payments or contributions by the County.
- 7.7 In the event of any final judicial determination or award of any matter covered by this section the County shall be responsible to third parties, pro rata, for any negligence determined to have been caused by the County.
- 7.8 Contractor's indemnification shall cover, and Contractor agrees to indemnify the County, in the manner provided for and to the extent described above, in the event the County is found to have been negligent for having selected Contractor to perform the work described in this Agreement.
- 7.9 The provision by Contractor of insurance shall not limit the liability of Contractor under this Agreement.
- 7.10 Contractor shall cause all Trade Contractors and any other Contractor who may have a contract to perform construction or installation work in the area where work will be performed under this Agreement, to agree to indemnify the County and to hold it harmless from all claims for bodily injury and property damage that arise may from said Contractor's operations. Such provisions shall be in form satisfactory to the County.
- 7.11 Loss Deduction Clause - The County shall be exempt from, and in no way liable, for, any sums of money, which may represent a deductible in any insurance policy. The payment of deductibles shall be the sole responsibility of Contractor and/or Trade Contractor providing such insurance.

8.0 PERMITS:

It shall be the sole responsibility of the successful vendor to obtain all required permits in the name of Fort Bend County.

9.0 SPECIFICATIONS AND PRICING:

Vendor is to complete pricing below to provide and install chain-link fencing and accessories to include all materials, supplies, equipment, tools, services, labor and supervision necessary as stated below.

- 9.1 Provide and install 515' lft of 6' + 1' tall galvanized chain-link fence (7' Overall height) to include the below:
 - 9.1.1 6' Tall 9-ga. 2" mesh galvanized
 - 9.1.2 1-5/8" Top rail (Sche.40) galvanized
 - 9.1.3 2" Line post (Sche.40) galvanized 10' on centers
 - 9.1.4 2-1/2" Terminals (Sche.40) galvanized
 - 9.1.5 1' – 3 Strand barbwire (45 Degrees outwards)
 - 9.1.6 9-ga. Tension wire

- 9.2 Provide, fabricate and install two (2) 20' wide x 6' + 1' tall galvanized chain-link cantilever roll gates (7' Overall height) to include the below:
 - 9.2.1 2-1/2" Top and bottom frame (Sche.40) galvanized
 - 9.2.2 2" Vertical braces galvanized
 - 9.2.3 6' Tall 9-ga. 2" mesh galvanized
 - 9.2.4 3/8" Truss rod system galvanized
 - 9.2.5 1' – 3 Strand barbwire (Straight-up)
 - 9.2.6 4" Support post (Sche.40) galvanized
 - 9.2.7 Neoprene rollers as needed
 - 9.2.8 Standard Cantilever gate latches with padlock provisions

Total cost: \$_____.

10.0 PROJECT DURATION:

Vendor agrees, if awarded the contract, to complete all work required by the contract documents **within 30 calendar days** after receipt of purchase order.

IN SUBMITTING THIS QUOTE, I CERTIFY that I will perform all the specified work and provide a first class job, and that I agree to provide and complete the above services as stated herein.

(signature of authorized vendor representative)

(printed name of authorized vendor representative)

(printed name of vendor)

(date)

11.0 FORT BEND COUNTY REPRESENTATIVE & QUESTIONS:

Point of contact for this contract is Cheryl Krejci, CPPB, Senior Buyer, cheryl.krejci@fortbendcountytexas.gov. Questions pertaining to this RFQ must be provided in writing by email to this address by **9:00 AM, Tuesday, January 28, 2014.**

12.0 REQUIRED FORMS:

All vendors submitting are required to complete the attached and return with submission:

- 12.1 Vendor Form
- 12.2 W9 Form
- 12.3 Tax Form/Debt/Residence Certification

total fence footage 545 ft 2 large gates for trucks and trailers.

add to existing fence

add to existing fence 6ft 3 strand bob wire

1 1 5'

Electrical Line from main power

1 5 0'

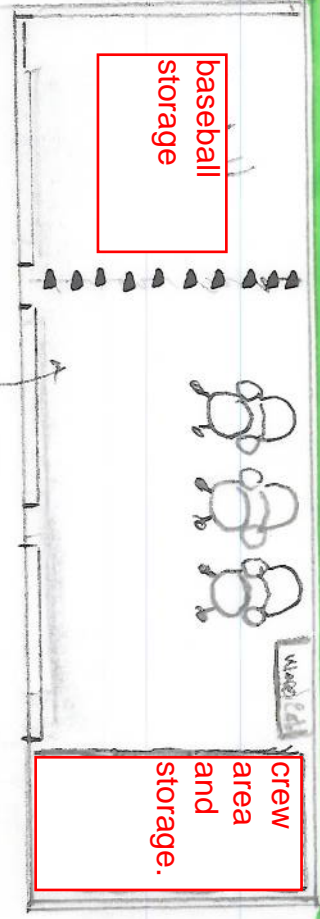
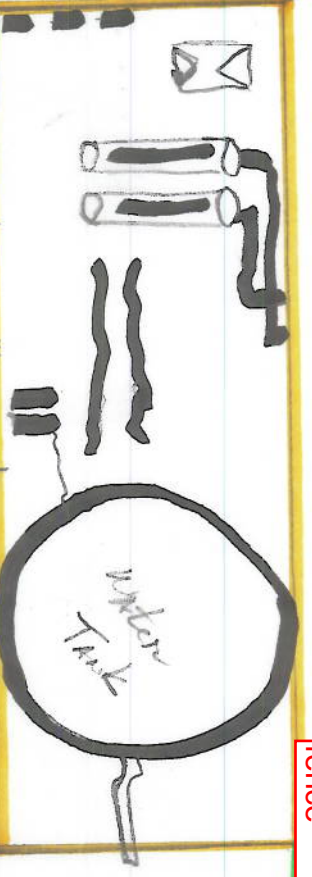

160'

130'

gate

Gate

Gate

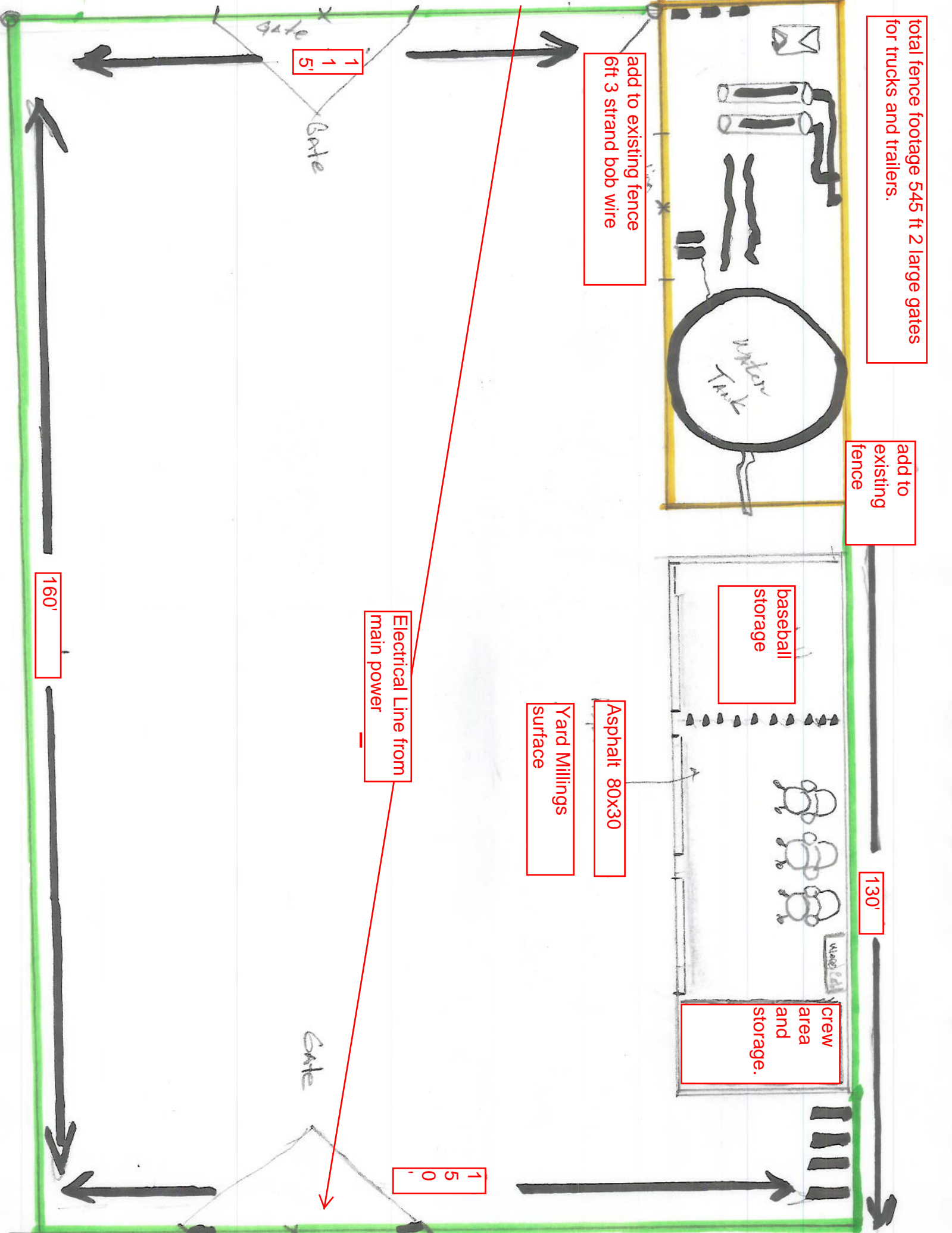



COUNTY PURCHASING AGENT
Fort Bend County, Texas

Gilbert D. Jalomo, Jr., CPPB
County Purchasing Agent

(281) 341-8640
Fax (281) 341-8642 or 341-8645

Vendor Information

Federal ID # or S.S #		Dun and Bradstreet #
Type of Business	<input type="checkbox"/> Corporation/LLC <input type="checkbox"/> Sole Proprietor/Individual <input type="checkbox"/> Partnership <input type="checkbox"/> Tax Exempt Organization	
Legal Company Name	Year Business was Established _____	
Remittance Address		
City/State/Zip		
Physical Address		
City/State/Zip		
County	<input type="checkbox"/> Fort Bend County Other: _____	
Phone/Fax Number	Phone: _____	Fax: _____
Contact Person		
E-mail		
Special Notes		
The Company listed above is a (check all that apply and attached certificate).	<input type="checkbox"/> DBE-Disadvantaged Business Enterprise Certification # _____ <input type="checkbox"/> SBE-Small Business Enterprise Certification # _____ <input type="checkbox"/> HUB-Texas Historically Underutilized Business Certification # _____ <input type="checkbox"/> WBE-Women's Business Enterprise Certification # _____ <input type="checkbox"/> MBE-Minority Business Enterprise Certification # _____	
Company's gross annual receipts:	<input type="checkbox"/> < \$500,000 <input type="checkbox"/> \$500,000-\$4,999,999 <input type="checkbox"/> \$5,000,000-\$16,999,999 <input type="checkbox"/> \$17,000,000-\$22,399,999 <input type="checkbox"/> >\$22,400,000	
NAICs codes (Please enter all that apply).		

PLEASE NOTE: W-9 needs to be attached in order to be entered into our system

Request for Taxpayer Identification Number and Certification

**Give form to the
 requester. Do not
 send to the IRS.**

Print or type See Specific Instructions on page 2.	Name (as shown on your income tax return)	
	Business name, if different from above	
	Check appropriate box: <input type="checkbox"/> Individual/Sole proprietor <input type="checkbox"/> Corporation <input type="checkbox"/> Partnership <input type="checkbox"/> Limited liability company. Enter the tax classification (D=disregarded entity, C=corporation, P=partnership) ▶ <input type="checkbox"/> Exempt payee <input type="checkbox"/> Other (see instructions) ▶	
	Address (number, street, and apt. or suite no.)	Requester's name and address (optional)
	City, state, and ZIP code	
	List account number(s) here (optional)	

Part I Taxpayer Identification Number (TIN)

Enter your TIN in the appropriate box. The TIN provided must match the name given on Line 1 to avoid backup withholding. For individuals, this is your social security number (SSN). However, for a resident alien, sole proprietor, or disregarded entity, see the Part I instructions on page 3. For other entities, it is your employer identification number (EIN). If you do not have a number, see *How to get a TIN* on page 3.

Social security number
or
Employer identification number

Note. If the account is in more than one name, see the chart on page 4 for guidelines on whose number to enter.

Part II Certification

Under penalties of perjury, I certify that:

1. The number shown on this form is my correct taxpayer identification number (or I am waiting for a number to be issued to me), and
2. I am not subject to backup withholding because: (a) I am exempt from backup withholding, or (b) I have not been notified by the Internal Revenue Service (IRS) that I am subject to backup withholding as a result of a failure to report all interest or dividends, or (c) the IRS has notified me that I am no longer subject to backup withholding, and
3. I am a U.S. citizen or other U.S. person (defined below).

Certification instructions. You must cross out item 2 above if you have been notified by the IRS that you are currently subject to backup withholding because you have failed to report all interest and dividends on your tax return. For real estate transactions, item 2 does not apply. For mortgage interest paid, acquisition or abandonment of secured property, cancellation of debt, contributions to an individual retirement arrangement (IRA), and generally, payments other than interest and dividends, you are not required to sign the Certification, but you must provide your correct TIN. See the instructions on page 4.

Sign Here	Signature of U.S. person ▶	Date ▶
------------------	----------------------------	--------

General Instructions

Section references are to the Internal Revenue Code unless otherwise noted.

Purpose of Form

A person who is required to file an information return with the IRS must obtain your correct taxpayer identification number (TIN) to report, for example, income paid to you, real estate transactions, mortgage interest you paid, acquisition or abandonment of secured property, cancellation of debt, or contributions you made to an IRA.

Use Form W-9 only if you are a U.S. person (including a resident alien), to provide your correct TIN to the person requesting it (the requester) and, when applicable, to:

1. Certify that the TIN you are giving is correct (or you are waiting for a number to be issued),
2. Certify that you are not subject to backup withholding, or
3. Claim exemption from backup withholding if you are a U.S. exempt payee. If applicable, you are also certifying that as a U.S. person, your allocable share of any partnership income from a U.S. trade or business is not subject to the withholding tax on foreign partners' share of effectively connected income.

Note. If a requester gives you a form other than Form W-9 to request your TIN, you must use the requester's form if it is substantially similar to this Form W-9.

Definition of a U.S. person. For federal tax purposes, you are considered a U.S. person if you are:

- An individual who is a U.S. citizen or U.S. resident alien,
- A partnership, corporation, company, or association created or organized in the United States or under the laws of the United States,
- An estate (other than a foreign estate), or
- A domestic trust (as defined in Regulations section 301.7701-7).

Special rules for partnerships. Partnerships that conduct a trade or business in the United States are generally required to pay a withholding tax on any foreign partners' share of income from such business. Further, in certain cases where a Form W-9 has not been received, a partnership is required to presume that a partner is a foreign person, and pay the withholding tax. Therefore, if you are a U.S. person that is a partner in a partnership conducting a trade or business in the United States, provide Form W-9 to the partnership to establish your U.S. status and avoid withholding on your share of partnership income.

The person who gives Form W-9 to the partnership for purposes of establishing its U.S. status and avoiding withholding on its allocable share of net income from the partnership conducting a trade or business in the United States is in the following cases:

- The U.S. owner of a disregarded entity and not the entity,

- The U.S. grantor or other owner of a grantor trust and not the trust, and
- The U.S. trust (other than a grantor trust) and not the beneficiaries of the trust.

Foreign person. If you are a foreign person, do not use Form W-9. Instead, use the appropriate Form W-8 (see Publication 515, Withholding of Tax on Nonresident Aliens and Foreign Entities).

Nonresident alien who becomes a resident alien. Generally, only a nonresident alien individual may use the terms of a tax treaty to reduce or eliminate U.S. tax on certain types of income. However, most tax treaties contain a provision known as a “saving clause.” Exceptions specified in the saving clause may permit an exemption from tax to continue for certain types of income even after the payee has otherwise become a U.S. resident alien for tax purposes.

If you are a U.S. resident alien who is relying on an exception contained in the saving clause of a tax treaty to claim an exemption from U.S. tax on certain types of income, you must attach a statement to Form W-9 that specifies the following five items:

1. The treaty country. Generally, this must be the same treaty under which you claimed exemption from tax as a nonresident alien.
2. The treaty article addressing the income.
3. The article number (or location) in the tax treaty that contains the saving clause and its exceptions.
4. The type and amount of income that qualifies for the exemption from tax.
5. Sufficient facts to justify the exemption from tax under the terms of the treaty article.

Example. Article 20 of the U.S.-China income tax treaty allows an exemption from tax for scholarship income received by a Chinese student temporarily present in the United States. Under U.S. law, this student will become a resident alien for tax purposes if his or her stay in the United States exceeds 5 calendar years. However, paragraph 2 of the first Protocol to the U.S.-China treaty (dated April 30, 1984) allows the provisions of Article 20 to continue to apply even after the Chinese student becomes a resident alien of the United States. A Chinese student who qualifies for this exception (under paragraph 2 of the first protocol) and is relying on this exception to claim an exemption from tax on his or her scholarship or fellowship income would attach to Form W-9 a statement that includes the information described above to support that exemption.

If you are a nonresident alien or a foreign entity not subject to backup withholding, give the requester the appropriate completed Form W-8.

What is backup withholding? Persons making certain payments to you must under certain conditions withhold and pay to the IRS 28% of such payments. This is called “backup withholding.” Payments that may be subject to backup withholding include interest, tax-exempt interest, dividends, broker and barter exchange transactions, rents, royalties, nonemployee pay, and certain payments from fishing boat operators. Real estate transactions are not subject to backup withholding.

You will not be subject to backup withholding on payments you receive if you give the requester your correct TIN, make the proper certifications, and report all your taxable interest and dividends on your tax return.

Payments you receive will be subject to backup withholding if:

1. You do not furnish your TIN to the requester,
2. You do not certify your TIN when required (see the Part II instructions on page 3 for details),
3. The IRS tells the requester that you furnished an incorrect TIN,

4. The IRS tells you that you are subject to backup withholding because you did not report all your interest and dividends on your tax return (for reportable interest and dividends only), or

5. You do not certify to the requester that you are not subject to backup withholding under 4 above (for reportable interest and dividend accounts opened after 1983 only).

Certain payees and payments are exempt from backup withholding. See the instructions below and the separate Instructions for the Requester of Form W-9.

Also see *Special rules for partnerships* on page 1.

Penalties

Failure to furnish TIN. If you fail to furnish your correct TIN to a requester, you are subject to a penalty of \$50 for each such failure unless your failure is due to reasonable cause and not to willful neglect.

Civil penalty for false information with respect to withholding. If you make a false statement with no reasonable basis that results in no backup withholding, you are subject to a \$500 penalty.

Criminal penalty for falsifying information. Willfully falsifying certifications or affirmations may subject you to criminal penalties including fines and/or imprisonment.

Misuse of TINs. If the requester discloses or uses TINs in violation of federal law, the requester may be subject to civil and criminal penalties.

Specific Instructions

Name

If you are an individual, you must generally enter the name shown on your income tax return. However, if you have changed your last name, for instance, due to marriage without informing the Social Security Administration of the name change, enter your first name, the last name shown on your social security card, and your new last name.

If the account is in joint names, list first, and then circle, the name of the person or entity whose number you entered in Part I of the form.

Sole proprietor. Enter your individual name as shown on your income tax return on the “Name” line. You may enter your business, trade, or “doing business as (DBA)” name on the “Business name” line.

Limited liability company (LLC). Check the “Limited liability company” box only and enter the appropriate code for the tax classification (“D” for disregarded entity, “C” for corporation, “P” for partnership) in the space provided.

For a single-member LLC (including a foreign LLC with a domestic owner) that is disregarded as an entity separate from its owner under Regulations section 301.7701-3, enter the owner’s name on the “Name” line. Enter the LLC’s name on the “Business name” line.

For an LLC classified as a partnership or a corporation, enter the LLC’s name on the “Name” line and any business, trade, or DBA name on the “Business name” line.

Other entities. Enter your business name as shown on required federal tax documents on the “Name” line. This name should match the name shown on the charter or other legal document creating the entity. You may enter any business, trade, or DBA name on the “Business name” line.

Note. You are requested to check the appropriate box for your status (individual/sole proprietor, corporation, etc.).

Exempt Payee

If you are exempt from backup withholding, enter your name as described above and check the appropriate box for your status, then check the “Exempt payee” box in the line following the business name, sign and date the form.

Generally, individuals (including sole proprietors) are not exempt from backup withholding. Corporations are exempt from backup withholding for certain payments, such as interest and dividends.

Note. If you are exempt from backup withholding, you should still complete this form to avoid possible erroneous backup withholding.

The following payees are exempt from backup withholding:

1. An organization exempt from tax under section 501(a), any IRA, or a custodial account under section 403(b)(7) if the account satisfies the requirements of section 401(f)(2),
2. The United States or any of its agencies or instrumentalities,
3. A state, the District of Columbia, a possession of the United States, or any of their political subdivisions or instrumentalities,
4. A foreign government or any of its political subdivisions, agencies, or instrumentalities, or
5. An international organization or any of its agencies or instrumentalities.

Other payees that may be exempt from backup withholding include:

6. A corporation,
7. A foreign central bank of issue,
8. A dealer in securities or commodities required to register in the United States, the District of Columbia, or a possession of the United States,
9. A futures commission merchant registered with the Commodity Futures Trading Commission,
10. A real estate investment trust,
11. An entity registered at all times during the tax year under the Investment Company Act of 1940,
12. A common trust fund operated by a bank under section 584(a),
13. A financial institution,
14. A middleman known in the investment community as a nominee or custodian, or
15. A trust exempt from tax under section 664 or described in section 4947.

The chart below shows types of payments that may be exempt from backup withholding. The chart applies to the exempt payees listed above, 1 through 15.

IF the payment is for . . .	THEN the payment is exempt for . . .
Interest and dividend payments	All exempt payees except for 9
Broker transactions	Exempt payees 1 through 13. Also, a person registered under the Investment Advisers Act of 1940 who regularly acts as a broker
Barter exchange transactions and patronage dividends	Exempt payees 1 through 5
Payments over \$600 required to be reported and direct sales over \$5,000 ¹	Generally, exempt payees 1 through 7

¹ See Form 1099-MISC, Miscellaneous Income, and its instructions.

² However, the following payments made to a corporation (including gross proceeds paid to an attorney under section 6045(f), even if the attorney is a corporation) and reportable on Form 1099-MISC are not exempt from backup withholding: medical and health care payments, attorneys' fees, and payments for services paid by a federal executive agency.

Part I. Taxpayer Identification Number (TIN)

Enter your TIN in the appropriate box. If you are a resident alien and you do not have and are not eligible to get an SSN, your TIN is your IRS individual taxpayer identification number (ITIN). Enter it in the social security number box. If you do not have an ITIN, see *How to get a TIN* below.

If you are a sole proprietor and you have an EIN, you may enter either your SSN or EIN. However, the IRS prefers that you use your SSN.

If you are a single-member LLC that is disregarded as an entity separate from its owner (see *Limited liability company (LLC)* on page 2), enter the owner's SSN (or EIN, if the owner has one). Do not enter the disregarded entity's EIN. If the LLC is classified as a corporation or partnership, enter the entity's EIN.

Note. See the chart on page 4 for further clarification of name and TIN combinations.

How to get a TIN. If you do not have a TIN, apply for one immediately. To apply for an SSN, get Form SS-5, Application for a Social Security Card, from your local Social Security Administration office or get this form online at www.ssa.gov. You may also get this form by calling 1-800-772-1213. Use Form W-7, Application for IRS Individual Taxpayer Identification Number, to apply for an ITIN, or Form SS-4, Application for Employer Identification Number, to apply for an EIN. You can apply for an EIN online by accessing the IRS website at www.irs.gov/businesses and clicking on Employer Identification Number (EIN) under Starting a Business. You can get Forms W-7 and SS-4 from the IRS by visiting www.irs.gov or by calling 1-800-TAX-FORM (1-800-829-3676).

If you are asked to complete Form W-9 but do not have a TIN, write "Applied For" in the space for the TIN, sign and date the form, and give it to the requester. For interest and dividend payments, and certain payments made with respect to readily tradable instruments, generally you will have 60 days to get a TIN and give it to the requester before you are subject to backup withholding on payments. The 60-day rule does not apply to other types of payments. You will be subject to backup withholding on all such payments until you provide your TIN to the requester.

Note. Entering "Applied For" means that you have already applied for a TIN or that you intend to apply for one soon.

Caution: A disregarded domestic entity that has a foreign owner must use the appropriate Form W-8.

Part II. Certification

To establish to the withholding agent that you are a U.S. person, or resident alien, sign Form W-9. You may be requested to sign by the withholding agent even if items 1, 4, and 5 below indicate otherwise.

For a joint account, only the person whose TIN is shown in Part I should sign (when required). Exempt payees, see *Exempt Payee* on page 2.

Signature requirements. Complete the certification as indicated in 1 through 5 below.

1. Interest, dividend, and barter exchange accounts opened before 1984 and broker accounts considered active during 1983. You must give your correct TIN, but you do not have to sign the certification.

2. Interest, dividend, broker, and barter exchange accounts opened after 1983 and broker accounts considered inactive during 1983. You must sign the certification or backup withholding will apply. If you are subject to backup withholding and you are merely providing your correct TIN to the requester, you must cross out item 2 in the certification before signing the form.

3. Real estate transactions. You must sign the certification. You may cross out item 2 of the certification.

4. Other payments. You must give your correct TIN, but you do not have to sign the certification unless you have been notified that you have previously given an incorrect TIN. "Other payments" include payments made in the course of the requester's trade or business for rents, royalties, goods (other than bills for merchandise), medical and health care services (including payments to corporations), payments to a nonemployee for services, payments to certain fishing boat crew members and fishermen, and gross proceeds paid to attorneys (including payments to corporations).

5. Mortgage interest paid by you, acquisition or abandonment of secured property, cancellation of debt, qualified tuition program payments (under section 529), IRA, Coverdell ESA, Archer MSA or HSA contributions or distributions, and pension distributions. You must give your correct TIN, but you do not have to sign the certification.

What Name and Number To Give the Requester

For this type of account:	Give name and SSN of:
1. Individual	The individual
2. Two or more individuals (joint account)	The actual owner of the account or, if combined funds, the first individual on the account ¹
3. Custodian account of a minor (Uniform Gift to Minors Act)	The minor ²
4. a. The usual revocable savings trust (grantor is also trustee)	The grantor-trustee ¹
b. So-called trust account that is not a legal or valid trust under state law	The actual owner ¹
5. Sole proprietorship or disregarded entity owned by an individual	The owner ³
For this type of account:	Give name and EIN of:
6. Disregarded entity not owned by an individual	The owner
7. A valid trust, estate, or pension trust	Legal entity ⁴
8. Corporate or LLC electing corporate status on Form 8832	The corporation
9. Association, club, religious, charitable, educational, or other tax-exempt organization	The organization
10. Partnership or multi-member LLC	The partnership
11. A broker or registered nominee	The broker or nominee
12. Account with the Department of Agriculture in the name of a public entity (such as a state or local government, school district, or prison) that receives agricultural program payments	The public entity

¹ List first and circle the name of the person whose number you furnish. If only one person on a joint account has an SSN, that person's number must be furnished.

² Circle the minor's name and furnish the minor's SSN.

³ You must show your individual name and you may also enter your business or "DBA" name on the second name line. You may use either your SSN or EIN (if you have one), but the IRS encourages you to use your SSN.

⁴ List first and circle the name of the trust, estate, or pension trust. (Do not furnish the TIN of the personal representative or trustee unless the legal entity itself is not designated in the account title.) Also see *Special rules for partnerships* on page 1.

Note. If no name is circled when more than one name is listed, the number will be considered to be that of the first name listed.

Secure Your Tax Records from Identity Theft

Identity theft occurs when someone uses your personal information such as your name, social security number (SSN), or other identifying information, without your permission, to commit fraud or other crimes. An identity thief may use your SSN to get a job or may file a tax return using your SSN to receive a refund.

To reduce your risk:

- Protect your SSN,
- Ensure your employer is protecting your SSN, and
- Be careful when choosing a tax preparer.

Call the IRS at 1-800-829-1040 if you think your identity has been used inappropriately for tax purposes.

Victims of identity theft who are experiencing economic harm or a system problem, or are seeking help in resolving tax problems that have not been resolved through normal channels, may be eligible for Taxpayer Advocate Service (TAS) assistance. You can reach TAS by calling the TAS toll-free case intake line at 1-877-777-4778 or TTY/TDD 1-800-829-4059.

Protect yourself from suspicious emails or phishing schemes.

Phishing is the creation and use of email and websites designed to mimic legitimate business emails and websites. The most common act is sending an email to a user falsely claiming to be an established legitimate enterprise in an attempt to scam the user into surrendering private information that will be used for identity theft.

The IRS does not initiate contacts with taxpayers via emails. Also, the IRS does not request personal detailed information through email or ask taxpayers for the PIN numbers, passwords, or similar secret access information for their credit card, bank, or other financial accounts.

If you receive an unsolicited email claiming to be from the IRS, forward this message to phishing@irs.gov. You may also report misuse of the IRS name, logo, or other IRS personal property to the Treasury Inspector General for Tax Administration at 1-800-366-4484. You can forward suspicious emails to the Federal Trade Commission at: spam@uce.gov or contact them at www.consumer.gov/idtheft or 1-877-IDTHEFT(438-4338).

Visit the IRS website at www.irs.gov to learn more about identity theft and how to reduce your risk.

Privacy Act Notice

Section 6109 of the Internal Revenue Code requires you to provide your correct TIN to persons who must file information returns with the IRS to report interest, dividends, and certain other income paid to you, mortgage interest you paid, the acquisition or abandonment of secured property, cancellation of debt, or contributions you made to an IRA, or Archer MSA or HSA. The IRS uses the numbers for identification purposes and to help verify the accuracy of your tax return. The IRS may also provide this information to the Department of Justice for civil and criminal litigation, and to cities, states, the District of Columbia, and U.S. possessions to carry out their tax laws. We may also disclose this information to other countries under a tax treaty, to federal and state agencies to enforce federal nontax criminal laws, or to federal law enforcement and intelligence agencies to combat terrorism.

You must provide your TIN whether or not you are required to file a tax return. Payers must generally withhold 28% of taxable interest, dividend, and certain other payments to a payee who does not give a TIN to a payer. Certain penalties may also apply.

