

*Fort Bend County, Texas  
Request for Qualifications*



*Design/Build for Restroom and Concession Building at Harlem Road Park for  
Fort Bend County  
RFQ 18-066*

**SUBMIT RFQS TO:**

Fort Bend County  
Purchasing Department  
Travis Annex  
301 Jackson, Suite 201  
Richmond, TX 77469

**Note:** All correspondence must include the term  
“Purchasing Department” in address to assist in  
proper delivery

**SUBMIT NO LATER THAN:**

Tuesday, May 15, 2018  
2:00 PM (Central)

**MARK ENVELOPE:**

RFQ 18-066  
Restroom and concession at Harlem Park

***ALL SUBMITTALS MUST BE RECEIVED AND TIME/DATE STAMPED BY THE PURCHASING OFFICE  
OF FORT BEND COUNTY ON OR BEFORE THE SPECIFIED TIME/DATE STATED ABOVE.***

***SUBMITTALS RECEIVED AS REQUIRED WILL THEN BE OPENED AND THE NAMES PUBLICLY READ.***

***SUBMITTALS RECEIVED AFTER THE SPECIFIED TIME WILL BE RETURNED UNOPENED.***

Results will not be given by phone.  
Results will be provided to bidder in writing  
after Commissioners Court award.

Requests for information must be in  
writing and directed to:

Jaime Kovar  
Assistant County Purchasing Agent  
[Jaime.kovar@fortbendcountytexas.gov](mailto:Jaime.kovar@fortbendcountytexas.gov)

**Vendor Responsibilities:**

- Download and complete any addendums. (Addendums will be posted on the Fort Bend County website no  
Later than 48 hours prior to bid opening)
- Submit response in accordance with requirements stated on the cover of this document.
- DO NOT submit responses via email or fax.



**COUNTY PURCHASING AGENT**  
Fort Bend County, Texas

**Vendor Information**

Debbie Kaminski, CPPB  
County Purchasing Agent

Office (281) 341-8640

Legal Company Name (top line of W9)		
Business Name (if different from legal name)		
Federal ID # or S.S. #		
Type of Business	<input type="checkbox"/> Corporation/LLC <input type="checkbox"/> Partnership <input type="checkbox"/> Sole Proprietor/Individual <input type="checkbox"/> Tax Exempt Organization	
Publicly Traded Business	<input type="checkbox"/> No <input type="checkbox"/> Yes    Ticker Symbol _____	
Remittance Address		
City/State/Zip		
Physical Address		
City/State/Zip		
Phone/Fax Number	Phone: _____                      Fax: _____	
Contact Person		
E-mail		
Check all that apply to the company listed above and provide certification number.	DBE-Disadvantaged Business Enterprise <input type="checkbox"/> <b>Certification #</b> _____ SBE-Small Business Enterprise <input type="checkbox"/> <b>Certification #</b> _____ HUB –Texas Historically Underutilized Business <input type="checkbox"/> <b>Certification #</b> _____ WBE-Women’s Business Enterprise <input type="checkbox"/> <b>Certification #</b> _____	
Company’s gross annual receipts	<\$500,000 <input type="checkbox"/>	\$500,000-\$4,999,999 <input type="checkbox"/>
	\$5,000,000-\$16,999,999 <input type="checkbox"/>	\$17,000,000-\$22,399,999 <input type="checkbox"/>
	>\$22,400,000 <input type="checkbox"/>	
NAICs codes (Please enter all that apply)		
Signature of Authorized Representative		
Printed Name		
Title		
Date		

**THIS FORM MUST BE SUBMITTED WITH THE SOLICITATION RESPONSE.**

## **1.0 Objective:**

Fort Bend County, herein requests Request for Qualifications from qualified firms for Design/Build services to construct a restroom and concession building at Harlem Road Park, located at 701 Harlem Road in Richmond, Texas. The Design/Build firm, herein referred to as “Respondent”, shall serve in the capacity of an Architect/Engineer and General Contractor. For reference only, please refer to Enclosure 1: Site Plan and Schematic Floor Plan.

## **2.0 General:**

- 2.1 The selected party will be requested to submit a proposal for a Design/Build contract under the provisions of the §2269.301 of the Texas Government Code.
- 2.2 Respondents should carefully read the information contained herein and submit a complete response to all requirements and questions as directed.
- 2.3 Submittals and any other Respondent information in response to this RFQ shall become the property of Fort Bend County.
- 2.4 Fort Bend County will not provide compensation to Respondents for any expenses incurred by the Respondent(s) for submittal preparation or for any demonstrations that may be made, unless otherwise expressly stated or required by law. Respondents submit qualifications at their own risk.
- 2.5 Each submittal should be prepared simply and economically, providing a straightforward, concise description of your firm’s ability to meet the requirements, and an understanding of the County’s needs.
- 2.6 Fort Bend County makes no guarantee that an award will be made as a result of this RFQ. Fort Bend County reserves the right to accept or reject any or all submittals, with or without cause, waive any formalities or minor technical inconsistencies, or delete any item/requirement from this RFQ or contract when deemed to be in the County’s best interest. Representations made within the qualifications submittal and any subsequent proposal will be binding on responding firms. Fort Bend County will not be bound to act by any previous communication or submittal by the firms other than those responding to this RFQ.

## **3.0 Texas Ethics Commission Form 1295:**

- 3.1 Effective January 1, 2016 all contracts executed by Commissioners Court, regardless of the dollar amount, will require completion of Form 1295 "Certificate of Interested Parties", per the new Government Code Statute §2252.908. All vendors submitting a response to a formal Bid, RFP, RFQ or any contracts, contract amendments, renewals or change orders are required to complete the Form 1295 online through the State of Texas Ethics Commission website. Please

visit:

[https://www.ethics.state.tx.us/whatsnew/elf\\_info\\_form1295.htm](https://www.ethics.state.tx.us/whatsnew/elf_info_form1295.htm).

3.2 On-line instructions:

3.2.1 Name of governmental entity is to read Fort Bend County.

3.2.2 Identification number used by the governmental entity is the solicitation number: RFQ 18-066.

3.3 Description is the title of the solicitation: Restroom and concession at Harlem Road Park

3.4 Highest evaluated vendor (s) will be required to provide the Form 1295 within three (3) calendar days from notification; however, if your company is publicly traded you are not required to complete this form.

**4.0 Insurance:**

4.1 All respondents must submit, with response, a current certificate of insurance indicating coverage in the amounts stated below. In lieu of submitting a certificate of insurance, respondents may submit, with RFQ, a notarized statement from an Insurance company, authorized to conduct business in the State of Texas, and acceptable to Fort Bend County, guaranteeing the issuance of an insurance policy, with the coverage stated below, to the firm named therein, if successful, upon award of this Contract. Failure to provide current insurance certificate or notarized statement will result in disqualification of submittal.

4.2 At contract execution, contractor shall furnish County with property executed certificates of insurance which shall evidence all insurance required and provide that such insurance shall not be canceled, except on 30 days prior written notice to County. Contractor shall provide certified copies of insurance endorsements and/or policies if requested by County. Contractor shall maintain such insurance coverage from the time Services commence until Services are completed and provide replacement certificates, policies and/or endorsements for any such insurance expiring prior to completion of Services. Contractor shall obtain such insurance written on an Occurrence form (or a Claims Made form for Professional Liability insurance) from such companies having Best's rating of A/VII or better, licensed or approved to transact business in the State of Texas, and shall obtain such insurance of the following types and minimum limits:

4.2.1 Workers' Compensation insurance. Substitutes to genuine Workers' Compensation Insurance will not be allowed.

- 4.2.2 Employers' Liability insurance with limits of not less than \$1,000,000 per injury by accident, \$1,000,000 per injury by disease, and \$1,000,000 per bodily injury by disease.
- 4.2.3 Commercial general liability insurance with a limit of not less than \$1,000,000 each occurrence and \$2,000,000 in the annual aggregate. Policy shall cover liability for bodily injury, personal injury, and property damage and products/completed operations arising out of the business operations of the policyholder.
- 4.2.4 Business Automobile Liability coverage with a combined Bodily Injury/Property Damage limit of not less than \$1,000,000 each accident. The policy shall cover liability arising from the operation of licensed vehicles by policyholder.
- 4.2.5 Professional Liability insurance may be made on a Claims Made form with limits not less than \$1,000,000.
- 4.3 County and the members of Commissioners Court shall be named as additional insured to all required coverage except for Workers' Compensation and Professional Liability (if required). All Liability policies including Workers' Compensation written on behalf of contractor, excluding Professional Liability, shall contain a waiver of subrogation in favor of County and members of Commissioners Court.
- 4.4 If required coverage is written on a claims-made basis, contractor warrants that any retroactive date applicable to coverage under the policy precedes the effective date of the contract; and that continuous coverage will be maintained or an extended discovery period will be exercised for a period of two (2) years beginning from the time that work under the agreement is completed.
- 4.5 Builder's Risk Insurance: Contractor is required to provide proof before a Purchase Order is issued for this project and keep in full force and effect until the Transfer Date, Builders Risk Insurance, subject to policy terms and conditions, of direct physical loss or damage to property, materials, equipment and supplies which are to become an integral part of the Project, whether owned by Contractor, or subcontractors of every tier, and in which one or more of same has an insurable interest, while in transit, while at the Construction Site awaiting construction, during construction, and until the Transfer Date. Such insurance shall be maintained to cover, as nearly as practicable, the insurable value of such property, materials, equipment and supplies at risk, and shall contain a waiver of subrogation in favor of Contractor, Architect, subcontractors of any tier and Owner for loss or damage occurring during the Work and shall name Contractor as the named insured and Owner as additional insureds. All Builder's Risk Insurance proceeds shall be paid directly to the Contractor.

## **5.0 Indemnification:**

Respondent shall save harmless County from and against all claims, liability, and expenses, including reasonable attorney's fees, arising from activities of respondent, its agents, servants or employees, performed under this agreement that result from the negligent act, error, or omission of respondent or any of respondent's agents, servants or employees.

- 5.1 Respondent shall timely report all such matters to Fort Bend County and shall, upon the receipt of any such claim, demand, suit, action, proceeding, lien or judgment, not later than the fifteenth day of each month; provide Fort Bend County with a written report on each such matter, setting forth the status of each matter, the schedule or planned proceedings with respect to each matter and the cooperation or assistance, if any, of Fort Bend County required by Respondent in the defense of each matter.
- 5.2 Respondent's duty to defend, indemnify and hold Fort Bend County harmless shall be absolute. It shall not abate or end by reason of the expiration or termination of any contract unless otherwise agreed by Fort Bend County in writing. The provisions of this section shall survive the termination of the contract and shall remain in full force and effect with respect to all such matters no matter when they arise.
- 5.3 In the event of any dispute between the parties as to whether a claim, demand, suit, action, proceeding, lien or judgment appears to have been caused by or appears to have arisen out of or in connection with acts or omissions of Respondent, Respondent shall never-the-less fully defend such claim, demand, suit, action, proceeding, lien or judgment until and unless there is a determination by a court of competent jurisdiction that the acts and omissions of Respondent are not at issue in the matter.
- 5.4 Respondent's indemnification shall cover, and Respondent agrees to indemnify Fort Bend County, in the event Fort Bend County is found to have been negligent for having selected Respondent to perform the work described in this request.
- 5.5 The provision by Respondent of insurance shall not limit the liability of Respondent under an agreement.
- 5.6 Respondent shall cause all trade contractors and any other contractor who may have a contract to perform construction or installation work in the area where work will be performed under this request, to agree to indemnify Fort Bend County and to hold it harmless from all claims for bodily injury and property damage that arise may from said Respondent's operations. Such provisions shall be in form satisfactory to Fort Bend County.
- 5.7 Loss Deduction Clause - Fort Bend County shall be exempt from, and in no way liable for, any sums of money which may represent a deductible in any insurance

policy. The payment of deductibles shall be the sole responsibility of Respondent and/or trade contractor providing such insurance.

**6.0 Prevailing Wages:**

This project is subject to the prevailing wage rate requirements of Chapter 2258 of the Government Code. The Contractor shall pay Fort Bend County sixty dollars (\$60.00) for each worker employed by the Contractor for the provision of services described herein for each calendar day or part of the day that the worker is paid less than the below stated rates. Contractors may also visit [www.wdol.gov/dba.aspx](http://www.wdol.gov/dba.aspx).

General Decision Number: TX170297 01/12/2018 TX297  
Superseded General Decision Number: TX20160297

State: Texas  
Construction Type: Building  
County: Fort Bend County in Texas.

**BUILDING CONSTRUCTION PROJECTS** (does not include single family homes or apartments up to and including 4 stories).

Note: Under Executive Order (EO) 13658, an hourly minimum wage of \$10.35 for calendar year 2018 applies to all contracts subject to the Davis-Bacon Act for which the contract is awarded (and any solicitation was issued) on or after January 1, 2015. If this contract is covered by the EO, the contractor must pay all workers in any classification listed on this wage determination at least \$10.35 (or the applicable wage rate listed on this wage determination, if it is higher) for all hours spent performing on the contract in calendar year 2018. The EO minimum wage rate will be adjusted annually. Additional information on contractor requirements and worker protections under the EO is available at [www.dol.gov/whd/govcontracts](http://www.dol.gov/whd/govcontracts).

Modification Number	Publication Date
0	01/05/2018
1	01/12/2018

ASBE0022-009 06/01/2017

	Rates	Fringes
ASBESTOS WORKER/HEAT & FROST INSULATOR (Duct, Pipe and Mechanical System Insulation)	\$ 23.26	12.92

BOIL0074-003 01/01/2017

BOILERMAKER	\$ 28.00	22.35
-------------	----------	-------

CARP0551-008 04/01/2016

CARPENTER (Excludes Acoustical Ceiling Installation, Drywall Hanging, Form Work and Metal Stud Installation)	\$ 23.05	8.78
ELEC0716-005 08/28/2017		
ELECTRICIAN (Excludes Low Voltage Wiring and Installation of Alarms)	\$ 32.25	9.14
* ELEV0031-003 01/01/2018		
ELEVATOR MECHANIC	\$ 41.28	32.645+a+b
FOOTNOTES:		
A. 6% under 5 years based on regular hourly rate for all hours worked. 8% over 5 years based on regular hourly rate for all hours worked.		
B. Holidays: New Year's Day; Memorial Day; Independence Day; Labor Day; Thanksgiving Day; Friday after Thanksgiving Day; Christmas Day; and Veterans Day.		
ENGI0450-002 04/01/2014		
POWER EQUIPMENT OPERATOR		
Cranes	\$ 34.85	9.85
IRON0084-002 06/01/2017		
IRONWORKER (ORNAMENTAL AND STRUCTURAL)	\$ 23.27	7.12
PLAS0079-004 01/01/2015		
PLASTERER	\$ 19.92	1.00
PLUM0068-002 10/01/2017		
PLUMBER	\$ 34.90	10.54
PLUM0211-010 10/01/2017		
PIPEFITTER (Including HVAC Pipe Installation)	\$ 34.10	11.71
SHEE0054-003 07/01/2017		
SHEET METAL WORKER (Excludes HVAC Duct and Unit Installation)	\$ 27.72	13.70
SUTX2014-023 07/21/2014		
ACOUSTICAL CEILING MECHANIC	\$ 16.41	3.98



BRICKLAYER	\$ 19.86	0.00
CAULKER	\$ 15.36	0.00
CEMENT MASON/CONCRETE FINISHER	\$ 13.82	0.00
DRYWALL FINISHER/TAPER	\$ 16.30	3.71
DRYWALL HANGER AND METAL STUD INSTALLER	\$ 17.45	3.96
ELECTRICIAN (Alarm Installation Only)	\$ 17.97	3.37
ELECTRICIAN (Low Voltage Wiring Only)	\$ 18.00	1.68
FLOOR LAYER: Carpet	\$ 20.00	0.00
FORM WORKER	\$ 11.87	0.00
GLAZIER	\$ 19.12	4.41
INSULATOR – BATT	\$ 14.87	0.73
IRONWORKER, REINFORCING	\$ 12.10	0.00
LABORER: Common or General	\$ 10.79	0.00
LABORER: Mason Tender – Brick	\$ 13.37	0.00
LABORER: Mason Tender - Cement/Concrete	\$ 10.50	0.00
LABORER: Pipelayer	\$ 12.94	0.00
LABORER: Roof Tearoff	\$ 11.28	0.00
LABORER: Landscape and Irrigation	\$ 9.49	0.00
LATHER	\$ 19.73	0.00
OPERATOR: Backhoe/Excavator/Trackhoe	\$ 14.10	0.00
OPERATOR: Bobcat/Skid Steer/Skid Loader	\$ 13.93	0.00
OPERATOR: Bulldozer	\$ 20.77	0.00
OPERATOR: Drill	\$ 16.22	0.34

OPERATOR: Forklift	\$ 15.64	0.00
OPERATOR: Grader/Blade	\$ 13.37	0.00
OPERATOR: Loader	\$ 13.55	0.94
OPERATOR: Mechanic	\$ 17.52	3.33
OPERATOR: Paver (Asphalt, Aggregate, and Concrete)	\$ 16.03	0.00
OPERATOR: Roller	\$ 16.00	0.00
PAINTER (Brush, Roller and Spray), Excludes Drywall Finishing/Taping	\$ 16.77	4.51
ROOFER	\$ 15.40	0.00
SHEET METAL WORKER (HVAC Duct Installation Only)	\$ 17.81	2.64
SHEET METAL WORKER (HVAC Unit Installation Only)	\$ 16.00	1.61
SPRINKLER FITTER (Fire Sprinklers)	\$ 22.17	9.70
TILE FINISHER	\$ 12.00	0.00
TILE SETTER	\$ 16.17	0.00
TRUCK DRIVER: 1/Single Axle Truck	\$ 14.95	5.23
TRUCK DRIVER: Dump Truck	\$ 12.39	1.18
TRUCK DRIVER: Flatbed Truck	\$ 19.65	8.57
TRUCK DRIVER: Semi-Trailer Truck	\$ 12.50	0.00
TRUCK DRIVER: Water Truck	\$ 12.00	4.11
WATERPROOFER	\$ 14.39	0.00

WELDERS - Receive rate prescribed for craft performing operation to which welding is incidental.

Note: Executive Order (EO) 13706, Establishing Paid Sick Leave for Federal Contractors applies to all contracts subject to the Davis-Bacon Act for which the contract is awarded (and any solicitation was issued) on or after January 1, 2017. If this contract is covered by the EO, the contractor must provide employees with 1 hour of paid sick leave for every 30 hours they work,

up to 56 hours of paid sick leave each year. Employees must be permitted to use paid sick leave for their own illness, injury or other health-related needs, including preventive care; to assist a family member (or person who is like family to the employee) who is ill, injured, or has other health-related needs, including preventive care; or for reasons resulting from, or to assist a family member (or person who is like family to the employee) who is a victim of, domestic violence, sexual assault, or stalking. Additional information on contractor requirements and worker protections under the EO is available at [www.dol.gov/whd/govcontracts](http://www.dol.gov/whd/govcontracts).

Unlisted classifications needed for work not included within the scope of the classifications listed may be added after award only as provided in the labor standards contract clauses (29CFR 5.5 (a) (1) (ii)).

The body of each wage determination lists the classification and wage rates that have been found to be prevailing for the cited type(s) of construction in the area covered by the wage determination. The classifications are listed in alphabetical order of "identifiers" that indicate whether the particular rate is a union rate (current union negotiated rate for local), a survey rate (weighted average rate) or a union average rate (weighted union average rate).

#### Union Rate Identifiers

A four letter classification abbreviation identifier enclosed in dotted lines beginning with characters other than "SU" or "UAVG" denotes that the union classification and rate were prevailing for that classification in the survey. Example: PLUM0198-005 07/01/2014. PLUM is an abbreviation identifier of the union which prevailed in the survey for this classification, which in this example would be Plumbers. 0198 indicates the local union number or district council number where applicable, i.e., Plumbers Local 0198. The next number, 005 in the example, is an internal number used in processing the wage determination. 07/01/2014 is the effective date of the most current negotiated rate, which in this example is July 1, 2014.

Union prevailing wage rates are updated to reflect all rate changes in the collective bargaining agreement (CBA) governing this classification and rate.

#### Survey Rate Identifiers

Classifications listed under the "SU" identifier indicate that no one rate prevailed for this classification in the survey and the published rate is derived by computing a weighted average rate based on all the rates reported in the survey for that classification. As this weighted average rate includes all rates reported in the survey, it may include both union and non-union rates. Example: SULA2012-007 5/13/2014. SU indicates the rates are survey rates based on a weighted average calculation of rates and are not majority rates. LA indicates the State of Louisiana. 2012 is the year of survey on which these classifications and rates are based. The next number, 007 in the example, is an internal number used in producing the wage determination. 5/13/2014 indicates the survey completion date for the classifications and rates under that identifier.

Survey wage rates are not updated and remain in effect until a new survey is conducted.

#### Union Average Rate Identifiers

Classification(s) listed under the UAVG identifier indicate that no single majority rate prevailed for those classifications; however, 100% of the data reported for the classifications was union data. EXAMPLE: UAVG-OH-0010 08/29/2014. UAVG indicates that the rate is a weighted union average rate. OH indicates the state. The next number, 0010 in the example, is an internal number used in producing the wage determination. 08/29/2014 indicates the survey completion date for the classifications and rates under that identifier.

A UAVG rate will be updated once a year, usually in January of each year, to reflect a weighted average of the current negotiated/CBA rate of the union locals from which the rate is based.

#### WAGE DETERMINATION APPEALS PROCESS

1.) Has there been an initial decision in the matter? This can be:

- \* an existing published wage determination
- \* a survey underlying a wage determination
- \* a Wage and Hour Division letter setting forth a position on a wage determination matter
- \* a conformance (additional classification and rate) ruling

On survey related matters, initial contact, including requests for summaries of surveys, should be with the Wage and Hour Regional Office for the area in which the survey was conducted because those Regional Offices have responsibility for the Davis-Bacon survey program. If the response from this initial contact is not satisfactory, then the process described in 2.) and 3.) should be followed.

With regard to any other matter not yet ripe for the formal process described here, initial contact should be with the Branch of Construction Wage Determinations. Write to:

Branch of Construction Wage Determinations  
Wage and Hour Division  
U.S. Department of Labor  
200 Constitution Avenue, N.W.  
Washington, DC 20210

2.) If the answer to the question in 1.) is yes, then an interested party (those affected by the action) can request review and reconsideration from the Wage and Hour Administrator (See 29 CFR Part 1.8 and 29 CFR Part 7). Write to:

Wage and Hour Administrator  
U.S. Department of Labor  
200 Constitution Avenue, N.W.  
Washington, DC 20210

The request should be accompanied by a full statement of the interested party's position and by any information (wage payment data, project description, area practice material, etc.) that the requestor considers relevant to the issue.

3.) If the decision of the Administrator is not favorable, an interested party may appeal directly to the Administrative Review Board (formerly the Wage Appeals Board). Write to:

Administrative Review Board  
U.S. Department of Labor  
200 Constitution Avenue, N.W.  
Washington, DC 20210

4.) All decisions by the Administrative Review Board are final.

**7.0 Pre-RFQ Conference:**

A Pre-RFQ conference will be conducted on **Tuesday, May 1, 2018 at 9:00 AM** (central). The pre-RFQ conference will be held at the Fort Bend County Purchasing Department located in the Travis Annex at 301 Jackson, Suite 201, Richmond, Texas 77469. All vendors are encouraged to attend. A site visit will be conducted after the conference, if necessary.

**8.0 Scope of Work:**

- 8.1 The project will consist of 1,320 square feet, pre-engineered structure with half serving as a covered pavilion and half enclosed to provide concessions and restroom facilities for park users.
- 8.2 Materials will include galvanized steel frame structure, metal panel roofing, split-face concrete masonry unity (CMU), hollow metal doors and frames, sealed concrete, and restroom fixtures.

**9.0 Estimated Budget:**

Estimated budget to complete this project is \$175,000.

**10.0 Estimated Schedule:**

Advertisement begins:	April 23, 2018
Pre-RFQ conference (with site visit if necessary):	May 1, 2018
Deadline for questions:	May 8, 2018
Responses due:	May 15, 2018
Evaluations begin:	May 21, 2018
Commissioners Court for permission to negotiate:	May 29, 2018
Final contract to Court:	June 26, 2018

**11.0 Format of Response, Qualifications, and Evaluation Factors:**

- 11.1 To facilitate evaluation of submittals, one (1) original, four (4) paper copies and one (1) electronic response on CD or flash drive is required. CD or flash drive must contain only one (1) file in PDF format and must match written response

identically. Failure to provide proper CD or flash drive will result in disqualification.

11.2 Request for Qualifications must take the form of a bound 8-1/2-inch by 11-inch report with a Table of Contents and all pages numbered in sequence (**maximum 25 pages**). Binding must allow reports to lay flat when open and may be either wire or GBC. Format of the report may be either “portrait” or “landscape” format with binding on either long or short side.

11.3 Respondents are required to follow the outline below when preparing their submission:

Tab	Title
	Title Page
	Letter of Transmittal
	Table of Contents
	Executive Summary
1	Understand Scope of Work
2	Firm’s Experience
3	Staff Experience
4	Financial Stability
5	Firm’s Management Plan
6	Required forms (insurance, vendor forms, W9, debt form, and Stormwater Management Program form)

11.4 Executive Summary - This part of the response to the RFQ should be limited to a brief narrative highlighting the Respondent’s submission. Note that the executive summary should identify the primary contacts for the Respondent.

11.5 Respondents will be evaluated utilizing the factors, as weighted below:

Understanding Scope of Work (weight factor = 30%)

Tab 1

- Understanding of Scope of Work: Parties demonstrate their ability to meet the required qualifications listed. In addition, describe how the services requested in this instrument will be provided and how they will be supported. Describe the approach your firm will take to the required collaboration, scheduling and coordination required for this project.

Firm’s Experience (weight factor = 25%)

Tab 2

- Firm Experience with Projects of Similar Size and Complexity: Such experience must be in the form of providing general

contracting services for municipal/county government facilities. List a minimum of three (3) similar projects completed within the last ten (10) years; provide the name, location, and description of each project, completion date, final cost, the client, and a contact person and phone number. Provide organization chart.

Staff Experience (weight factor = 25%)

Tab 3

- Staff Experience with Projects of Similar Size and Complexity: Such experience must be in the form of providing project management and construction services on projects. List a minimum of three (3) similar projects completed within the last ten (10) years; provide the name and location of each project, the client, and a contact person and phone number and completion date. In addition, provide resumes for project superintendent and project manager who will be assigned to this project.

Financial Stability (weight factor = 5%)

Tab 4

- Complete and accurate responses to the following questions:
  - a. Has your Company ever failed to complete any work awarded to it in the last ten (10) years?
  - b. Are there any judgments, claims, arbitration proceedings or suits pending or outstanding against your Company or its officers in the last ten (10) years?
  - c. Has your Company filed any lawsuits or requested arbitration with regard to construction contracts within the last five (5) years? If yes, please provide details.
  - d. Does your company have the ability to obtain payment and performance bonds required for this project?

Firm's Management Plan (weight factor = 10%)

Tab 5

- Firm's Management System, Software and Cost Control. Describe how the construction management services will be provided and how they will be supported.

Overall Completeness of Proposal (weight factor = 5%)

Tab 6

- Proof of Insurance
- Completed Respondent forms
- Completed W9 form
- Completed debt form
- Completed Contractor Acknowledgement of Stormwater Management Program form

**12.0 Selection Process:**

Request for Qualifications will be evaluated by a committee comprised of County staff. The committee will review Request for Qualifications submitted and may develop a short list of not more than three (3) firms. These firms will be requested to submit additional information and may be invited to interview with the Committee. Based on further review after the interviews, the committee will forward their recommendations to the Fort Bend County Commissioners Court.

**13.0 Performance and Payment Bonds:**

The successful firm, upon execution of agreement, will be required to provide to the Office of the County Purchasing Agent, a performance bond and a payment bond, each in the amount of 100% of the total contract sum within ten (10) calendar days after receipt of notification of bid award. Such bonds shall be executed by a corporate surety duly authorized and admitted to do business in the State of Texas and licensed in the State of Texas to issue surety bonds with a Best Rating of "A" or better. Fort Bend County reserves the right to accept or reject any surety company proposed by the Contractor. In the event Fort Bend County rejects the proposed surety company, the Contractor will be afforded five (5) additional days to submit the required bonds issued by a surety company acceptable to Fort Bend County.

**14.0 Retainage:**

Within thirty (30) days after receipt of each uncontested Application for Payment together with the supporting materials required, County shall advance to Contractor the uncontested amount requested in such uncontested Application for Payment, except *five* percent (5%) of the amount requested (hereafter "Retainage") in each Application for Payment by County. The Retainage withheld shall be released upon final completion of the entire Project and verification of satisfactory work performed, unless grounds exist for withholding payment on account of other defaults by Contractor, including services provided by its sub-contractors.



**15.0 Questions:**

Questions about this Statement of Qualification Package should be directed in writing to Jaime Kovar, Assistant County Purchasing Agent at [Jaime.Kovar@fortbendcountytexas.gov](mailto:Jaime.Kovar@fortbendcountytexas.gov). **Questions will be accepted until 10:00 AM, Tuesday, May 8, 2018.**

**16.0 STATE LAW REQUIREMENTS FOR CONTRACTS:**

The contents of this section are required by Texas Law and are included by County regardless of content.

- 16.1 Agreement to Not Boycott Israel Chapter 2270 Texas Government Code: By signature on vendor form, Contractor verifies Contractor does not boycott Israel and will not boycott Israel during the term of this Contract.
- 16.2 Texas Government Code Section 2251.152 Acknowledgment: By signature on vendor form, Contractor represents pursuant to Section 2252.152 of the Texas Government Code, that Contractor is not listed on the website of the Comptroller of the State of Texas concerning the listing of companies that are identified under Section 806.051, Section 807.051 or Section 2253.153.

**17.0 Additional Required Forms:**

All respondents submitting are required to complete the attached and return with submission:

- 17.1 Vendor Information Form
- 17.2 W9 Form
- 17.3 Tax Form/Debt/Residence Certification
- 17.4 Contractor Acknowledgement of Stormwater Management Program

**18.0 ENCLOSURES:**

Enclosure 1: Site Plan and Schematic Floor Plan



**Note.** If you are a U.S. person and a requester gives you a form other than Form W-9 to request your TIN, you must use the requester's form if it is substantially similar to this Form W-9.

**Definition of a U.S. person.** For federal tax purposes, you are considered a U.S. person if you are:

- An individual who is a U.S. citizen or U.S. resident alien;
- A partnership, corporation, company, or association created or organized in the United States or under the laws of the United States;
- An estate (other than a foreign estate); or
- A domestic trust (as defined in Regulations section 301.7701-7).

**Special rules for partnerships.** Partnerships that conduct a trade or business in the United States are generally required to pay a withholding tax under section 1446 on any foreign partners' share of effectively connected taxable income from such business. Further, in certain cases where a Form W-9 has not been received, the rules under section 1446 require a partnership to presume that a partner is a foreign person, and pay the section 1446 withholding tax. Therefore, if you are a U.S. person that is a partner in a partnership conducting a trade or business in the United States, provide Form W-9 to the partnership to establish your U.S. status and avoid section 1446 withholding on your share of partnership income.

In the cases below, the following person must give Form W-9 to the partnership for purposes of establishing its U.S. status and avoiding withholding on its allocable share of net income from the partnership conducting a trade or business in the United States:

- In the case of a disregarded entity with a U.S. owner, the U.S. owner of the disregarded entity and not the entity;
- In the case of a grantor trust with a U.S. grantor or other U.S. owner, generally, the U.S. grantor or other U.S. owner of the grantor trust and not the trust; and
- In the case of a U.S. trust (other than a grantor trust), the U.S. trust (other than a grantor trust) and not the beneficiaries of the trust.

**Foreign person.** If you are a foreign person or the U.S. branch of a foreign bank that has elected to be treated as a U.S. person, do not use Form W-9. Instead, use the appropriate Form W-8 or Form 8233 (see Publication 515, Withholding of Tax on Nonresident Aliens and Foreign Entities).

**Nonresident alien who becomes a resident alien.** Generally, only a nonresident alien individual may use the terms of a tax treaty to reduce or eliminate U.S. tax on certain types of income. However, most tax treaties contain a provision known as a "saving clause." Exceptions specified in the saving clause may permit an exemption from tax to continue for certain types of income even after the payee has otherwise become a U.S. resident alien for tax purposes.

If you are a U.S. resident alien who is relying on an exception contained in the saving clause of a tax treaty to claim an exemption from U.S. tax on certain types of income, you must attach a statement to Form W-9 that specifies the following five items:

1. The treaty country. Generally, this must be the same treaty under which you claimed exemption from tax as a nonresident alien.
2. The treaty article addressing the income.
3. The article number (or location) in the tax treaty that contains the saving clause and its exceptions.
4. The type and amount of income that qualifies for the exemption from tax.
5. Sufficient facts to justify the exemption from tax under the terms of the treaty article.

**Example.** Article 20 of the U.S.-China income tax treaty allows an exemption from tax for scholarship income received by a Chinese student temporarily present in the United States. Under U.S. law, this student will become a resident alien for tax purposes if his or her stay in the United States exceeds 5 calendar years. However, paragraph 2 of the first Protocol to the U.S.-China treaty (dated April 30, 1984) allows the provisions of Article 20 to continue to apply even after the Chinese student becomes a resident alien of the United States. A Chinese student who qualifies for this exception (under paragraph 2 of the first protocol) and is relying on this exception to claim an exemption from tax on his or her scholarship or fellowship income would attach to Form W-9 a statement that includes the information described above to support that exemption.

If you are a nonresident alien or a foreign entity, give the requester the appropriate completed Form W-8 or Form 8233.

## Backup Withholding

**What is backup withholding?** Persons making certain payments to you must under certain conditions withhold and pay to the IRS 28% of such payments. This is called "backup withholding." Payments that may be subject to backup withholding include interest, tax-exempt interest, dividends, broker and barter exchange transactions, rents, royalties, nonemployee pay, payments made in settlement of payment card and third party network transactions, and certain payments from fishing boat operators. Real estate transactions are not subject to backup withholding.

You will not be subject to backup withholding on payments you receive if you give the requester your correct TIN, make the proper certifications, and report all your taxable interest and dividends on your tax return.

**Payments you receive will be subject to backup withholding if:**

1. You do not furnish your TIN to the requester,
2. You do not certify your TIN when required (see the Part II instructions on page 3 for details),

3. The IRS tells the requester that you furnished an incorrect TIN,

4. The IRS tells you that you are subject to backup withholding because you did not report all your interest and dividends on your tax return (for reportable interest and dividends only), or

5. You do not certify to the requester that you are not subject to backup withholding under 4 above (for reportable interest and dividend accounts opened after 1983 only).

Certain payees and payments are exempt from backup withholding. See *Exempt payee code* on page 3 and the separate Instructions for the Requester of Form W-9 for more information.

Also see *Special rules for partnerships* above.

## What is FATCA reporting?

The Foreign Account Tax Compliance Act (FATCA) requires a participating foreign financial institution to report all United States account holders that are specified United States persons. Certain payees are exempt from FATCA reporting. See *Exemption from FATCA reporting code* on page 3 and the Instructions for the Requester of Form W-9 for more information.

## Updating Your Information

You must provide updated information to any person to whom you claimed to be an exempt payee if you are no longer an exempt payee and anticipate receiving reportable payments in the future from this person. For example, you may need to provide updated information if you are a C corporation that elects to be an S corporation, or if you no longer are tax exempt. In addition, you must furnish a new Form W-9 if the name or TIN changes for the account; for example, if the grantor of a grantor trust dies.

## Penalties

**Failure to furnish TIN.** If you fail to furnish your correct TIN to a requester, you are subject to a penalty of \$50 for each such failure unless your failure is due to reasonable cause and not to willful neglect.

**Civil penalty for false information with respect to withholding.** If you make a false statement with no reasonable basis that results in no backup withholding, you are subject to a \$500 penalty.

**Criminal penalty for falsifying information.** Willfully falsifying certifications or affirmations may subject you to criminal penalties including fines and/or imprisonment.

**Misuse of TINs.** If the requester discloses or uses TINs in violation of federal law, the requester may be subject to civil and criminal penalties.

## Specific Instructions

### Line 1

You must enter one of the following on this line; **do not** leave this line blank. The name should match the name on your tax return.

If this Form W-9 is for a joint account, list first, and then circle, the name of the person or entity whose number you entered in Part I of Form W-9.

a. **Individual.** Generally, enter the name shown on your tax return. If you have changed your last name without informing the Social Security Administration (SSA) of the name change, enter your first name, the last name as shown on your social security card, and your new last name.

**Note. ITIN applicant:** Enter your individual name as it was entered on your Form W-7 application, line 1a. This should also be the same as the name you entered on the Form 1040/1040A/1040EZ you filed with your application.

b. **Sole proprietor or single-member LLC.** Enter your individual name as shown on your 1040/1040A/1040EZ on line 1. You may enter your business, trade, or "doing business as" (DBA) name on line 2.

c. **Partnership, LLC that is not a single-member LLC, C Corporation, or S Corporation.** Enter the entity's name as shown on the entity's tax return on line 1 and any business, trade, or DBA name on line 2.

d. **Other entities.** Enter your name as shown on required U.S. federal tax documents on line 1. This name should match the name shown on the charter or other legal document creating the entity. You may enter any business, trade, or DBA name on line 2.

e. **Disregarded entity.** For U.S. federal tax purposes, an entity that is disregarded as an entity separate from its owner is treated as a "disregarded entity." See Regulations section 301.7701-2(c)(2)(iii). Enter the owner's name on line 1. The name of the entity entered on line 1 should never be a disregarded entity. The name on line 1 should be the name shown on the income tax return on which the income should be reported. For example, if a foreign LLC that is treated as a disregarded entity for U.S. federal tax purposes has a single owner that is a U.S. person, the U.S. owner's name is required to be provided on line 1. If the direct owner of the entity is also a disregarded entity, enter the first owner that is not disregarded for federal tax purposes. Enter the disregarded entity's name on line 2, "Business name/disregarded entity name." If the owner of the disregarded entity is a foreign person, the owner must complete an appropriate Form W-8 instead of a Form W-9. This is the case even if the foreign person has a U.S. TIN.

**Line 2**

If you have a business name, trade name, DBA name, or disregarded entity name, you may enter it on line 2.

**Line 3**

Check the appropriate box in line 3 for the U.S. federal tax classification of the person whose name is entered on line 1. Check only one box in line 3.

**Limited Liability Company (LLC).** If the name on line 1 is an LLC treated as a partnership for U.S. federal tax purposes, check the "Limited Liability Company" box and enter "P" in the space provided. If the LLC has filed Form 8832 or 2553 to be taxed as a corporation, check the "Limited Liability Company" box and in the space provided enter "C" for C corporation or "S" for S corporation. If it is a single-member LLC that is a disregarded entity, do not check the "Limited Liability Company" box; instead check the first box in line 3 "Individual/sole proprietor or single-member LLC."

**Line 4, Exemptions**

If you are exempt from backup withholding and/or FATCA reporting, enter in the appropriate space in line 4 any code(s) that may apply to you.

**Exempt payee code.**

- Generally, individuals (including sole proprietors) are not exempt from backup withholding.
- Except as provided below, corporations are exempt from backup withholding for certain payments, including interest and dividends.
- Corporations are not exempt from backup withholding for payments made in settlement of payment card or third party network transactions.
- Corporations are not exempt from backup withholding with respect to attorneys' fees or gross proceeds paid to attorneys, and corporations that provide medical or health care services are not exempt with respect to payments reportable on Form 1099-MISC.

The following codes identify payees that are exempt from backup withholding. Enter the appropriate code in the space in line 4.

- 1—An organization exempt from tax under section 501(a), any IRA, or a custodial account under section 403(b)(7) if the account satisfies the requirements of section 401(f)(2)
- 2—The United States or any of its agencies or instrumentalities
- 3—A state, the District of Columbia, a U.S. commonwealth or possession, or any of their political subdivisions or instrumentalities
- 4—A foreign government or any of its political subdivisions, agencies, or instrumentalities
- 5—A corporation
- 6—A dealer in securities or commodities required to register in the United States, the District of Columbia, or a U.S. commonwealth or possession
- 7—A futures commission merchant registered with the Commodity Futures Trading Commission
- 8—A real estate investment trust
- 9—An entity registered at all times during the tax year under the Investment Company Act of 1940
- 10—A common trust fund operated by a bank under section 584(a)
- 11—A financial institution
- 12—A middleman known in the investment community as a nominee or custodian
- 13—A trust exempt from tax under section 664 or described in section 4947

The following chart shows types of payments that may be exempt from backup withholding. The chart applies to the exempt payees listed above, 1 through 13.

IF the payment is for . . .	THEN the payment is exempt for . . .
Interest and dividend payments	All exempt payees except for 7
Broker transactions	Exempt payees 1 through 4 and 6 through 11 and all C corporations. S corporations must not enter an exempt payee code because they are exempt only for sales of noncovered securities acquired prior to 2012.
Barter exchange transactions and patronage dividends	Exempt payees 1 through 4
Payments over \$600 required to be reported and direct sales over \$5,000 <sup>1</sup>	Generally, exempt payees 1 through 5 <sup>2</sup>
Payments made in settlement of payment card or third party network transactions	Exempt payees 1 through 4

<sup>1</sup> See Form 1099-MISC, Miscellaneous Income, and its instructions.

<sup>2</sup> However, the following payments made to a corporation and reportable on Form 1099-MISC are not exempt from backup withholding: medical and health care payments, attorneys' fees, gross proceeds paid to an attorney reportable under section 6045(f), and payments for services paid by a federal executive agency.

**Exemption from FATCA reporting code.** The following codes identify payees that are exempt from reporting under FATCA. These codes apply to persons submitting this form for accounts maintained outside of the United States by certain foreign financial institutions. Therefore, if you are only submitting this form for an account you hold in the United States, you may leave this field blank. Consult with the person requesting this form if you are uncertain if the financial institution is subject to these requirements. A requester may indicate that a code is not required by providing you with a Form W-9 with "Not Applicable" (or any similar indication) written or printed on the line for a FATCA exemption code.

A—An organization exempt from tax under section 501(a) or any individual retirement plan as defined in section 7701(a)(37)

B—The United States or any of its agencies or instrumentalities

C—A state, the District of Columbia, a U.S. commonwealth or possession, or any of their political subdivisions or instrumentalities

D—A corporation the stock of which is regularly traded on one or more established securities markets, as described in Regulations section 1.1472-1(c)(1)(i)

E—A corporation that is a member of the same expanded affiliated group as a corporation described in Regulations section 1.1472-1(c)(1)(i)

F—A dealer in securities, commodities, or derivative financial instruments (including notional principal contracts, futures, forwards, and options) that is registered as such under the laws of the United States or any state

G—A real estate investment trust

H—A regulated investment company as defined in section 851 or an entity registered at all times during the tax year under the Investment Company Act of 1940

I—A common trust fund as defined in section 584(a)

J—A bank as defined in section 581

K—A broker

L—A trust exempt from tax under section 664 or described in section 4947(a)(1)

M—A tax exempt trust under a section 403(b) plan or section 457(g) plan

**Note.** You may wish to consult with the financial institution requesting this form to determine whether the FATCA code and/or exempt payee code should be completed.

**Line 5**

Enter your address (number, street, and apartment or suite number). This is where the requester of this Form W-9 will mail your information returns.

**Line 6**

Enter your city, state, and ZIP code.

**Part I. Taxpayer Identification Number (TIN)**

**Enter your TIN in the appropriate box.** If you are a resident alien and you do not have and are not eligible to get an SSN, your TIN is your IRS individual taxpayer identification number (ITIN). Enter it in the social security number box. If you do not have an ITIN, see *How to get a TIN* below.

If you are a sole proprietor and you have an EIN, you may enter either your SSN or EIN. However, the IRS prefers that you use your SSN.

If you are a single-member LLC that is disregarded as an entity separate from its owner (see *Limited Liability Company (LLC)* on this page), enter the owner's SSN (or EIN, if the owner has one). Do not enter the disregarded entity's EIN. If the LLC is classified as a corporation or partnership, enter the entity's EIN.

**Note.** See the chart on page 4 for further clarification of name and TIN combinations.

**How to get a TIN.** If you do not have a TIN, apply for one immediately. To apply for an SSN, get Form SS-5, Application for a Social Security Card, from your local SSA office or get this form online at [www.ssa.gov](http://www.ssa.gov). You may also get this form by calling 1-800-772-1213. Use Form W-7, Application for IRS Individual Taxpayer Identification Number, to apply for an ITIN, or Form SS-4, Application for Employer Identification Number, to apply for an EIN. You can apply for an EIN online by accessing the IRS website at [www.irs.gov/businesses](http://www.irs.gov/businesses) and clicking on Employer Identification Number (EIN) under Starting a Business. You can get Forms W-7 and SS-4 from the IRS by visiting [IRS.gov](http://IRS.gov) or by calling 1-800-TAX-FORM (1-800-829-3676).

If you are asked to complete Form W-9 but do not have a TIN, apply for a TIN and write "Applied For" in the space for the TIN, sign and date the form, and give it to the requester. For interest and dividend payments, and certain payments made with respect to readily tradable instruments, generally you will have 60 days to get a TIN and give it to the requester before you are subject to backup withholding on payments. The 60-day rule does not apply to other types of payments. You will be subject to backup withholding on all such payments until you provide your TIN to the requester.

**Note.** Entering "Applied For" means that you have already applied for a TIN or that you intend to apply for one soon.

**Caution:** A disregarded U.S. entity that has a foreign owner must use the appropriate Form W-8.

**Part II. Certification**

To establish to the withholding agent that you are a U.S. person, or resident alien, sign Form W-9. You may be requested to sign by the withholding agent even if items 1, 4, or 5 below indicate otherwise.

For a joint account, only the person whose TIN is shown in Part I should sign (when required). In the case of a disregarded entity, the person identified on line 1 must sign. Exempt payees, see *Exempt payee code* earlier.

**Signature requirements.** Complete the certification as indicated in items 1 through 5 below.

- 1. Interest, dividend, and barter exchange accounts opened before 1984 and broker accounts considered active during 1983.** You must give your correct TIN, but you do not have to sign the certification.
- 2. Interest, dividend, broker, and barter exchange accounts opened after 1983 and broker accounts considered inactive during 1983.** You must sign the certification or backup withholding will apply. If you are subject to backup withholding and you are merely providing your correct TIN to the requester, you must cross out item 2 in the certification before signing the form.
- 3. Real estate transactions.** You must sign the certification. You may cross out item 2 of the certification.
- 4. Other payments.** You must give your correct TIN, but you do not have to sign the certification unless you have been notified that you have previously given an incorrect TIN. "Other payments" include payments made in the course of the requester's trade or business for rents, royalties, goods (other than bills for merchandise), medical and health care services (including payments to corporations), payments to a nonemployee for services, payments made in settlement of payment card and third party network transactions, payments to certain fishing boat crew members and fishermen, and gross proceeds paid to attorneys (including payments to corporations).
- 5. Mortgage interest paid by you, acquisition or abandonment of secured property, cancellation of debt, qualified tuition program payments (under section 529), IRA, Coverdell ESA, Archer MSA or HSA contributions or distributions, and pension distributions.** You must give your correct TIN, but you do not have to sign the certification.

**What Name and Number To Give the Requester**

For this type of account:	Give name and SSN of:
1. Individual	The individual
2. Two or more individuals (joint account)	The actual owner of the account or, if combined funds, the first individual on the account <sup>1</sup>
3. Custodian account of a minor (Uniform Gift to Minors Act)	The minor <sup>2</sup>
4. a. The usual revocable savings trust (grantor is also trustee) b. So-called trust account that is not a legal or valid trust under state law	The grantor-trustee <sup>1</sup>  The actual owner <sup>1</sup>
5. Sole proprietorship or disregarded entity owned by an individual	The owner <sup>3</sup>
6. Grantor trust filing under Optional Form 1099 Filing Method 1 (see Regulations section 1.671-4(b)(2)(i)(A))	The grantor*
For this type of account:	Give name and EIN of:
7. Disregarded entity not owned by an individual	The owner
8. A valid trust, estate, or pension trust	Legal entity <sup>4</sup>
9. Corporation or LLC electing corporate status on Form 8832 or Form 2553	The corporation
10. Association, club, religious, charitable, educational, or other tax-exempt organization	The organization
11. Partnership or multi-member LLC	The partnership
12. A broker or registered nominee	The broker or nominee
13. Account with the Department of Agriculture in the name of a public entity (such as a state or local government, school district, or prison) that receives agricultural program payments	The public entity
14. Grantor trust filing under the Form 1041 Filing Method or the Optional Form 1099 Filing Method 2 (see Regulations section 1.671-4(b)(2)(i)(B))	The trust

<sup>1</sup> List first and circle the name of the person whose number you furnish. If only one person on a joint account has an SSN, that person's number must be furnished.

<sup>2</sup> Circle the minor's name and furnish the minor's SSN.

<sup>3</sup> You must show your individual name and you may also enter your business or DBA name on the "Business name/disregarded entity" name line. You may use either your SSN or EIN (if you have one), but the IRS encourages you to use your SSN.

<sup>4</sup> List first and circle the name of the trust, estate, or pension trust. (Do not furnish the TIN of the personal representative or trustee unless the legal entity itself is not designated in the account title.) Also see *Special rules for partnerships* on page 2.

\*Note. Grantor also must provide a Form W-9 to trustee of trust.

**Note.** If no name is circled when more than one name is listed, the number will be considered to be that of the first name listed.

**Secure Your Tax Records from Identity Theft**

Identity theft occurs when someone uses your personal information such as your name, SSN, or other identifying information, without your permission, to commit fraud or other crimes. An identity thief may use your SSN to get a job or may file a tax return using your SSN to receive a refund.

To reduce your risk:

- Protect your SSN,
- Ensure your employer is protecting your SSN, and
- Be careful when choosing a tax preparer.

If your tax records are affected by identity theft and you receive a notice from the IRS, respond right away to the name and phone number printed on the IRS notice or letter.

If your tax records are not currently affected by identity theft but you think you are at risk due to a lost or stolen purse or wallet, questionable credit card activity or credit report, contact the IRS Identity Theft Hotline at 1-800-908-4490 or submit Form 14039.

For more information, see Publication 4535, Identity Theft Prevention and Victim Assistance.

Victims of identity theft who are experiencing economic harm or a system problem, or are seeking help in resolving tax problems that have not been resolved through normal channels, may be eligible for Taxpayer Advocate Service (TAS) assistance. You can reach TAS by calling the TAS toll-free case intake line at 1-877-777-4778 or TTY/TDD 1-800-829-4059.

**Protect yourself from suspicious emails or phishing schemes.** Phishing is the creation and use of email and websites designed to mimic legitimate business emails and websites. The most common act is sending an email to a user falsely claiming to be an established legitimate enterprise in an attempt to scam the user into surrendering private information that will be used for identity theft.

The IRS does not initiate contacts with taxpayers via emails. Also, the IRS does not request personal detailed information through email or ask taxpayers for the PIN numbers, passwords, or similar secret access information for their credit card, bank, or other financial accounts.

If you receive an unsolicited email claiming to be from the IRS, forward this message to [phishing@irs.gov](mailto:phishing@irs.gov). You may also report misuse of the IRS name, logo, or other IRS property to the Treasury Inspector General for Tax Administration (TIGTA) at 1-800-366-4484. You can forward suspicious emails to the Federal Trade Commission at: [spam@uce.gov](mailto:spam@uce.gov) or contact them at [www.ftc.gov/idtheft](http://www.ftc.gov/idtheft) or 1-877-IDTHEFT (1-877-438-4338).

Visit [IRS.gov](http://IRS.gov) to learn more about identity theft and how to reduce your risk.

**Privacy Act Notice**

Section 6109 of the Internal Revenue Code requires you to provide your correct TIN to persons (including federal agencies) who are required to file information returns with the IRS to report interest, dividends, or certain other income paid to you; mortgage interest you paid; the acquisition or abandonment of secured property; the cancellation of debt; or contributions you made to an IRA, Archer MSA, or HSA. The person collecting this form uses the information on the form to file information returns with the IRS, reporting the above information. Routine uses of this information include giving it to the Department of Justice for civil and criminal litigation and to cities, states, the District of Columbia, and U.S. commonwealths and possessions for use in administering their laws. The information also may be disclosed to other countries under a treaty, to federal and state agencies to enforce civil and criminal laws, or to federal law enforcement and intelligence agencies to combat terrorism. You must provide your TIN whether or not you are required to file a tax return. Under section 3406, payers must generally withhold a percentage of taxable interest, dividend, and certain other payments to a payee who does not give a TIN to the payer. Certain penalties may also apply for providing false or fraudulent information.



**Mandatory Form**



**Contractor Acknowledgement of Stormwater Management Program**

I hereby acknowledge that I am aware of the stormwater management program and standard operating procedures developed by Fort Bend County in compliance with the TPDES General Permit No. TXR040000. I agree to comply with all applicable best management practices and standard operating procedures while conducting my services for Fort Bend County. I agree to conduct all services in a manner that does not introduce illicit discharges of pollutants to streets, stormwater inlets, drainage ditches or any portion of the drainage system. The following materials and/or pollutant sources must not be discharged to the drainage system as a result of any services provided:

1. Grass clippings, leaves, mulch, rocks, sand, dirt or other waste materials resulting from landscaping activities, (except those materials resulting from ditch mowing or maintenance activities)
2. Herbicides, pesticides and/or fertilizers, (except those intended for aquatic use)
3. Detergents, fuels, solvents, oils and/or lubricants, other equipment and/or vehicle fluids,
4. Other hazardous materials including paints, thinners, chemicals or related waste materials,
5. Uncontrolled dewatering discharges, equipment and/or vehicle wash waters,
6. Sanitary waste, trash, debris, or other waste products
7. Wastewater from wet saw machinery,
8. Other pollutants that degrade water quality or pose a threat to human health or the environment.

Furthermore, I agree to notify Fort Bend County immediately of any issue caused by or identified by:

\_\_\_\_\_  
(Company/Contractor)

that is believed to be an immediate threat to human health or the environment.

\_\_\_\_\_  
Contractor Signature

\_\_\_\_\_  
Date

\_\_\_\_\_  
Printed Name

\_\_\_\_\_  
Title

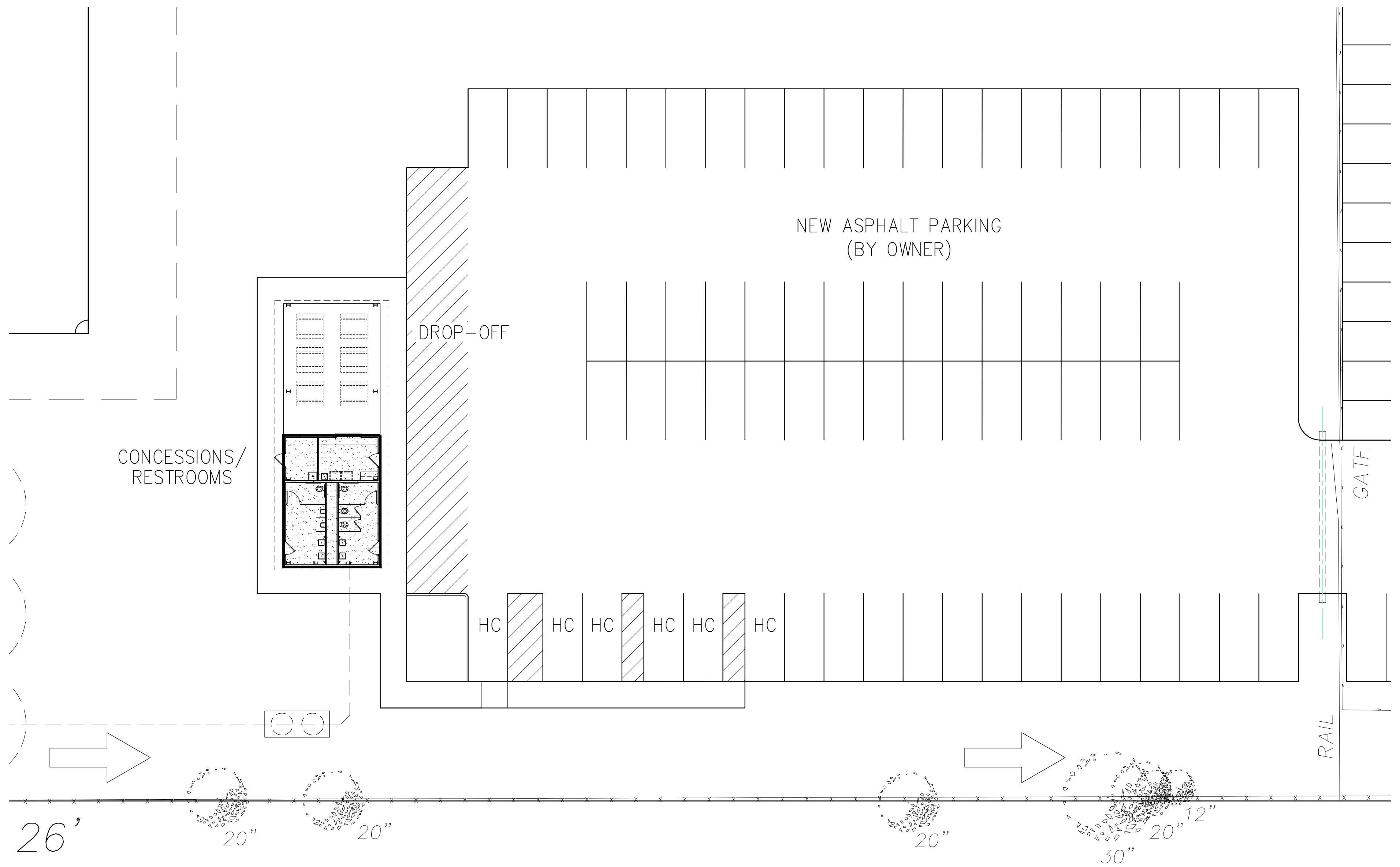

SITE PLAN  
CONCESSIONS/RESTROOMS



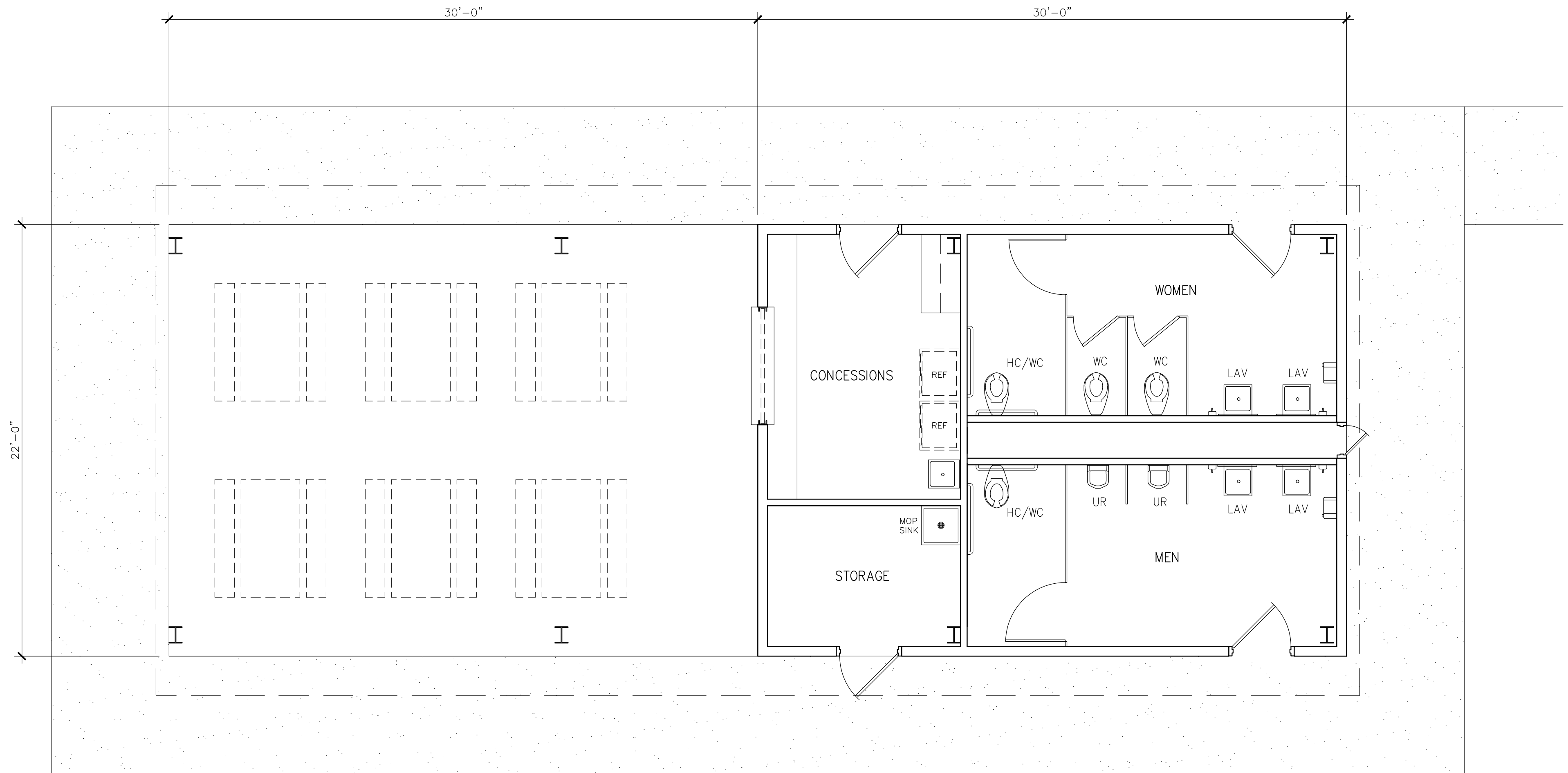

HARLEM ROAD PARK  
RESTROOM / CONCESSIONS

SCALE: 1/4" = 1'-0"